

ELLENSBURG - YAKIMA RIVER AND PARKS SEASONAL WALK
Central Washington Sun Striders - In Kittitas County
6K and 10K - Y1151 - Rating 1C (flat but uneven ground)
IF AN EMERGENCY DIAL 911

This OSB information packet consists of the following three pages of information:

1. This information page with driving directions, restroom and other info.
2. The 6K and 10K River and Parks walk directions page.
3. The 6K and 10K River and Parks map.

Driving directions to the Ellensburg River and Parks 6K and 10K walk start at Rotary Park

From Snoqualmie Pass:

Drive east on I-90. Take Exit 106 Ellensburg. You will curve over the freeway. Turn RIGHT (take the first exit) off the roundabout onto Dolarway Road. Follow Dolarway Road to the stop light at 5th Avenue. Turn RIGHT on 5th Ave and at the end of 5th, ANGLE SLIGHTLY LEFT into Rotary Park. Park on the right side of the parking lot after the dog park along the large soccer field area.

From Yakima or Vantage:

Drive west on I-90. Take Exit 109 Ellensburg. At the stop light, turn RIGHT on Canyon Road toward downtown Ellensburg. Turn LEFT at the stop light on Umptanum Road. Turn RIGHT on Anderson Road (small street sign!). Anderson changes to Railroad Avenue. Turn LEFT at the stop light onto 5th Avenue and at the end of 5th, ANGLE SLIGHTLY LEFT into Rotary Park. Park on the right side of the parking lot after the dog park along the large soccer field area.

Rotary Park Coordinates: **46.59' 38.27" N 120.33' 51.59" W**

Restrooms:

RRs at Rotary Park just after you start the walk and vault toilets at the Carey Lakes parking lot.

Words-to-the-Wise and Other Info:

During cold mornings in the late fall, winter and early spring, there may be icy patches especially where temps are below freezing at night and where the sun hasn't shone on or melted ice on walk surfaces. In winter, there will likely be patches of snow. During hot summer days, carry water and bring your own shade as some portions of the walk are unshaded.

Thanks for participating in our Ellensburg River and Parks walk. There is another club sanctioned walk in downtown Ellensburg and the CWU campus. There are sanctioned walks relatively close by in Cle Elum, South Cle Elum, Suncadia, Roslyn, Yakima and Vantage.

Be sure to log back into the OSB system (my.ava.org) to finish/complete your online registration after doing the walk. The OSB system does not deduct any walking fee from a walker's Event Bank until they have submitted walk completion info including the date the event was walked, the distance walked, and the selection of applicable special programs that walker is participating in. (Nevertheless, a fee of \$2 for a downloaded pdf is deducted from the user's Event Bank when the pdf is downloaded. Later, any pdf fees are credited back to a walker's Event Bank when he/she submits the walk completion info as a paying for credit walker.) The \$2 "coupon" for the downloaded pdf expires in 60 days.

POC: J. Blazek 509-899-6535 joemblazek1@gmail.com 1/7/2026

ELLENSBURG - RIVER AND PARKS - Y1151 - 6K & 10K - CENTRAL WASH SUN STRIDERS - RATED 1C

Flooding Note: If there is **any flooding along the river, walk on the paved dike road. Larger floods may block both routes. If you can't do this route, remember our in-town walk. DOGS - On-Leash Only.** (No dogs in picnic swimming area). **If an EMERGENCY: call 911.**

6K and 10K start with #1 - #7.

1. Facing the soccer fields, turn **LEFT** on the sidewalk and follow it as it **CURVES LEFT** at the vehicle turnaround. (*RR bldg straight ahead*).
2. Facing the restrooms, veer **RIGHT** on an asphalt path with a line of poplars on your left. **Continue** on the path across the unimproved part of the park, past the solar farm, under the freeway and into Irene Rinehart Park.
3. At the parking lot, turn **RIGHT** and proceed along the road to the end of the two lakes. Take the gravel trail that **CURVES** to the **LEFT** around the end of the lakes.
4. At the other side of the lake, keep **LEFT**, going onto the dike path (lake on your left/river on your right) and follow it back to the paved park road.
5. Go **STRAIGHT** onto the road crossing the creek.
6. Just after the creek, take the trail to the **RIGHT**.
7. At next large wooden bridge, 6K walkers turn **AROUND** and return the way you came. 10K walkers skip to #10.

6K walkers continue with #8.

8. At the road, turn **LEFT** and **RE-CROSS** the creek.
9. Stay on left shoulder of road to the parking lot. Turn **RIGHT** on the paved trail and proceed back under the freeway. *Now skip to and do #27 - #33.*

10K walkers do #10 - #33.

10. Turn **RIGHT**, **CROSS** the bridge, and take trail to the **LEFT**.
11. At "Y" take the trail to the **RIGHT** (along river).
12. At intersection of paths, take the **RIGHT**. (*This goes along the river edge. Keep river on your right*)
13. Keep going to the **RIGHT** when the other trail branch joins on your left.
14. Turn **AROUND** at the parking lot (*Port-a-potty*)
15. Re-enter the trail, keeping to the **RIGHT**. (*Stay on main trail. None of the small side trails are used. If you get off the main trail, keep the dike road on your right and the river on your left.*)
16. At the "Y" in the main trail, keep to the **RIGHT**.
17. At the next intersection with a main trail, turn **RIGHT** and **CROSS** the small wooden footbridge.

18. Jog **RIGHT** to **CROSS** the large wooden bridge, then turn **LEFT** on the dirt trail.
19. When the forest trail exits onto the paved park road, turn **LEFT** on the road crossing over the creek.
20. Leave the road continuing **STRAIGHT** onto the gravel path with the grassy area on your right.
21. Follow the dike trail, keeping between river and the lakes.
22. At the end of the lakes and at the end of the off dog leash swim area at a gravel trail junction, continue **STRAIGHT** on the path. (*river on your left*).
23. The path will go a bit farther along the river, will **CURVE** to the **RIGHT** at the slough. (*slough on left*)
24. Near end of slough (*close to freeway*), follow gravel path to **RIGHT** as it **CURVES** back toward the lakes paralleling the freeway (*on your left*).
25. Continue **STRAIGHT** on path which becomes paved road.
26. Turn **LEFT** on the asphalt trail opposite paved parking area and the vault toilets, and follow the path along the creek and under the freeway.

Both 6K and 10K do #27 - #33

27. Just after crossing under freeway, go **LEFT** on the gravel trail which goes up and on the dike.
28. Follow the dike trail to a reader signboard kiosk. At the kiosk, turn **RIGHT** staying on the gravel dike trail.
29. At Dolarway Road, turn **AROUND** and return to the kiosk.
30. Turn **LEFT** and continue on the gravel dike trail.
31. At the first trail to the left, turn **LEFT** down off the dike trail (*between two large willow trees*).
32. **ANGLE SLIGHTLY RIGHT** to follow the edge of the soccer fields toward parking lot. (*no real trail here*).
33. At end of grass soccer fields, turn **RIGHT** on the asphalt sidewalk back to your vehicle.

These directions may be used only by persons duly registered for this AVA/IVV sanctioned event.
POC: J. Blazek, 509-899-6535 © 2026 Central Washington Sun Striders

Eburg River Parks

10K  6K 

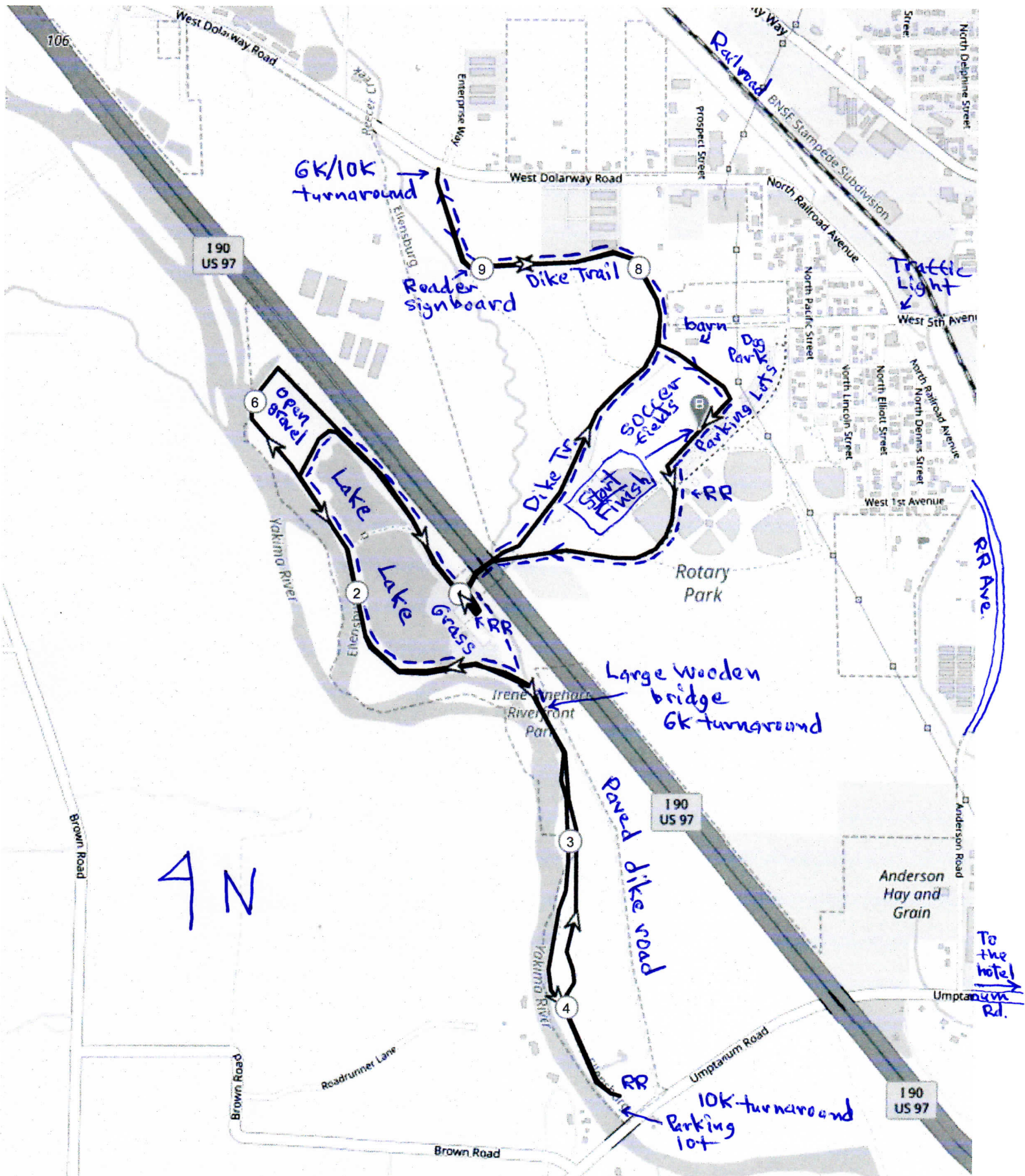

AN

