

VANTAGE - SEASONAL EVENT Y2184

7K COMMUNITY AND GINKGO STATE PARK VISITOR CENTER WALK 3K GINKGO STATE PARK "TREES OF STONE" HIKE 6K PALOUSE TO CASCADES STATE PARK RAIL TRAIL WALK

N 46.94084 W 119.98487

Central Washington Sun Striders Kittitas County, Washington

The Vantage seasonal walk/hike event consists of three separate walking and hiking routes and distances in the Vantage, Washington area. All three routes start with driving directions to the Vantage boat launch because there are vault toilets or portapotties there. None of these three routes has any shade so bring your own shade and water on warm or hot days. There is a small restaurant and store in the Vantage community.

The 7K is a walk along the Columbia River and around the community of Vantage. This includes the Ginkgo State Park Interpretative Visitor Center with its petrified logs and Native American Petroglyphs. The walk has great views up and down the Columbia River. The walk starts and ends at the Vantage boat launch parking lot on the Columbia River. It has some elevation gain/loss leaving the boat launch parking lot. Most of the trail is on pavement but there is a small portion on grass and on a dirt/gravel trail. Vault toilets/porta potties are at the boat launch parking lot and there are restrooms at the Ginkgo State Park Interpretative Visitor Center. Rated 2B.

The 3K is a hike up and down hills on a somewhat rough, rocky hiking trail in the "Trees of Stone" exhibit area of Ginkgo State Park. You see many examples of petrified logs on the landscape and there are great views of the surrounding area from the ridge top trail. You drive 2.5 miles from the Vantage boat launch to the parking lot. A Discover Pass is required to park in the lot though you can park for free along the highway just past the parking lot. Daily Discover Passes are available in the parking lot. There is a vault toilet at the "Trees of Stone" parking lot. Rated 3C.

The 6K is an out and back walk on a portion of the Palouse to Cascades State Park Rail Trail that goes across the Columbia River on the railroad grade and railroad bridge that was once part of the Chicago, Milwaukee and Puget Sound Railroad (The Milwaukee Road). There are great views of the river and Wanapum Dam from the bridge. You drive 7 1/2 miles from the Vantage boat launch to the gravel parking lot trailhead. A Discover Pass is not required to park in the gravel lot. There is a porta potty at the trailhead. Rated 1B.

Be sure to log back into the OSB system (my.ava.org) to finish/complete your online registration after doing the walk. The OSB system does not deduct any walking fee from a walker's Event Bank until they have submitted walk completion info including the date the event was walked, the distance walked, and the selection of applicable special programs that walker is participating in. (Nevertheless, a fee of \$2 for a downloaded pdf is deducted from the user's Event Bank when the pdf is downloaded. Later, any pdf fees are credited back to a walker's Event Bank when he/she submits the walk completion info as a paying for credit walker.) The \$2 "coupon" for the downloaded PDF expires in 60 days.

VANTAGE - SEASONAL EVENT Y2184
7K COMMUNITY AND GINKGO STATE PARK VISITOR CENTER WALK
3K GINKGO STATE PARK "TREES OF STONE" HIKE
6K PALOUSE TO CASCADES STATE PARK RAIL TRAIL WALK

Central Washington Sun Striders in Kittitas County, Washington

This on-line packet of info contains the following 8 pages of information:

1. This Table of Content's page.
2. Detailed information on each of the three separate walks/hikes that make up the Vantage event. (one page)
3. Driving directions and walk directions for the Vantage Community and Ginkgo State Park Visitor Center 7K walk. (Page1 of the 5 page walk directions and maps).
4. Map of the Vantage Community and Ginkgo State Park Visitor Center 7K walk. (Page 2 of the 5 page walk directions and maps).
5. Driving directions and walk directions for the "Trees of Stone" 3K hiking trail. (Page 3 of the 5 pages of walk directions and maps).
6. Map of the "Trees of Stone" 3K hiking trail. (Page 4 of the 5 pages of walk directions and maps).
7. Driving directions, walk directions and map for the Palouse to Cascades St Pk Railtrail 6K walk. (Page 5 of the 5 pages of walk directions and maps).
8. A Vicinity map of the Vantage area and the State Parks showing the relative locations of the three events in the Vantage area. (one page)

VANTAGE - 7K COMMUNITY & GINKGO STATE PARK VISITOR CENTER WALK Y2184 CENTRAL WASHINGTON SUN STRIDERS - 7K Rated 2B

Driving Directions to walk start at Vantage boat launch parking lot 46.56' 26.86" N 119.59' 07.11"W

1. On I-90, take Exit 136 (Vantage/Huntzinger Rd) to the stop sign. Turn **LEFT** toward Vantage.
2. Just past the freeway interchange, turn **RIGHT** on Boat Ramp Rd and go downhill keeping to the **RIGHT** to the boat launch parking area. Park in the single vehicle parking area nearest the restrooms. If they are full then park across on the other side of the parking lot or in the gravel area. Don't park in the boat trailer parking slots.

Vault Toilets/Porta Potties available at boat launch parking lot. Restrooms are available at the State Park Interpretive Center. Don't leave valuables in your car. If there is an Emergency, call 911.

7K Walk Directions (Mostly on pavement and road shoulders with some grassy areas)

1. On the sidewalk facing the restrooms, turn **RIGHT** and proceed on the sidewalk to the boat ramp/launch area.
2. Turn **AROUND** and return back toward the restrooms.
3. At gravel area just before the restrooms, turn **RIGHT** on the gravel trail. Follow it as it **CURVES** clockwise toward the river.
4. As it curves to the left, go **STRAIGHT** ahead on narrow grassy peninsula to the end at the edge of the river.
5. Turn **AROUND** and return to the gravel trail.
6. Turn **RIGHT** on the trail. It turns into a concrete path along the edge of the river.
7. At next junction, turn **RIGHT** on concrete path that turns into a wooden boardwalk.
8. At end of boardwalk, turn **RIGHT** on grassy peninsula and follow it to the end at the fountain/sculpture at edge of river.
9. Turn **AROUND** and return on wooden boardwalk, concrete path and gravel path back to boat launch parking lot sidewalk in front of the restrooms.
10. Turn **RIGHT** on sidewalk and proceed up and out of the parking lot on right edge of Boat Ramp Rd to Main Street.
11. Carefully **CROSS** Main St and turn **RIGHT** after the fir trees but before Blustery's. Parallel Main St in front of the Vantage businesses. *Watch for traffic as you walk by the businesses.*
12. Just after the grocery/general store, turn **RIGHT** on the short access road, carefully **CROSS** Main St and **proceed** on Joyce St. to a "T".
13. Turn **RIGHT** on Columbia Avenue.
14. Turn **LEFT** on Wayne Street.
15. Wayne turns **LEFT** and becomes Lakeview Ave.
16. Turn **LEFT** on Kittitas St.
17. Turn **RIGHT** on Columbia Ave.
18. Turn **LEFT** on Brown St.
19. Turn **RIGHT** on Ginkgo Ave and proceed to Ginkgo Petrified Forest State Park entrance.
20. **Proceed** into State Park. At (one way traffic) parking area loop, walk clockwise around parking loop facing traffic to left front corner of the visitor center. (*Restrooms in parking area*).
21. **Proceed STRAIGHT** on asphalt path around left side of visitor center to the back of the visitor center overlooking the river.
22. Turn **AROUND** and return to parking lot and turn **LEFT** to the front entrance steps of the visitor center.
23. Continue **STRAIGHT** on paved trail in front of visitor center and proceed on "Trail to Indian Picture Rocks" "60 yards".
24. At the "T", Turn **LEFT** on paved trail and proceed to petroglyphs at end of paved trail.
25. Turn **AROUND** and retrace your steps back on paved trail to where the chain/rock fence turns away from the paved trail.
26. Turn **LEFT** on dirt trail keeping chain fence on your left and proceed to the river overlook.
27. Turn **RIGHT** out to the road.
28. Turn **LEFT** on the road and proceed to the State Park entrance (white) gate.
29. Just past gate, angle **RIGHT** at the "Y" on old asphalt road.
30. Turn **AROUND** at the 3rd overhead power line and return to the "Y" at the park entrance. The 3rd set of overhead lines is just before the road starts to descend downhill.
31. Turn **RIGHT** on Ginkgo Ave. (no street sign)
32. Turn **LEFT** on Brown St.
33. Road turns **RIGHT** and becomes Lakeview Ave.
34. Road turns **RIGHT** and becomes Wayne Street.
35. Turn **LEFT** on Main Street.
36. Turn **LEFT** on Boat Ramp Rd back to start.

POC: J. Blazek 509-899-6535

Thank you for walking our Vantage community walk.

The walk directions and maps may only be used in conjunction with a signed AVA athletic waiver. All other uses are prohibited.

© 2024 Central Washington Sun Striders

Community Walk

Columbia River

Scale 1" = 1000'

4N

Columbia River

Gingko St. Pk
Visitor Center
Interpretive Center

== Other roads/streets
— Walk route

Columbia River

To 3K
"Trees of
Stone"
hike

Vantage Hwy

Gingko Ave

Brown

Kittitas

Lake View

Vantage

Wagne

Holiday

Lake & Fountain

Maring

Boat launch

Start/Finish

I-90
To Seattle

Exit 136

I-90
To Spokane

Huntzinger Road

To 6K
Rail &
Trail
Walk

**VANTAGE - 3K "TREES OF STONE" HIKING TRAIL Y2184
CENTRAL WASHINGTON SUN STRIDERS - 3K Rated 3C**

Driving Directions to Vantage boat launch parking lot 46.56' 26.86" N 119.59' 07.11"W

1. On I-90, take Exit 136 (Vantage/Huntzinger Rd) to the stop sign. Turn **LEFT** toward Vantage.
2. Just past the freeway interchange, turn **RIGHT** on Boat Ramp Rd and go downhill keeping **RIGHT** to the boat launch parking area. Park in the single vehicle parking area nearest the restrooms. If full, then park across on the other side of the parking lot or in the gravel area. Don't park in the boat trailer parking slots. Vault Toilets/porta potties available here.

Driving Directions from Vantage boat launch parking lot to 3K hike start 46.56' 51.49"N 120.02' 10.46"W

1. Drive out Boat Ramp Road to the stop sign at Main Street (no sign). Turn **RIGHT** on Main Street. Drive 2.5 miles.
2. Just past Vantage, Main Street **CURVES LEFT** and becomes Vantage Hwy. The parking lot for this hike is just after a road sign that says, "Ginkgo Petrified Forest Interp Trail ¼ mile". The gravel parking lot requires a Discover Pass (\$10 daily Discover Passes are available in the parking lot) or you can park along the Vantage Hwy for free (there is a wide spot along the highway just past the far end of the parking lot). Vault toilet is available in the parking lot. Don't leave valuables in your car.

If there is an Emergency call 911.

This 3K hikes the "Trees of Stone" Interpretive trail). You will hike past all of the exhibits. There is a seasonal drinking fountain at the rock house. There is no shade on this hike. Watch out for rattlesnakes near the house.

1. At lower end of parking lot, **PROCEED** up asphalt trail through rock house passageway (*drinking fountain at exit of rock house*).
2. Continue **STRAIGHT** ahead on the asphalt trail past 2 dirt way trails and 1 gravel trail (all on left) to exhibit 1 at a trail junction.
3. Turn **SHARP LEFT** and uphill on the gravel path (*small sign points to exhibits 4-22*) and pass exhibits 4, 5 and 6. Soon after exhibit 6, there is a way trail that comes down from the right (unmarked). Stay **STRAIGHT** on the main trail.
4. Immediately after the way trail, the main trail will **CURVE LEFT** and there will be a junction with a gravel trail that goes downhill to the left (unmarked). Stay **STRAIGHT** on the main trail. You'll then go uphill on two short but steep right and left switchbacks. (*Don't go up the steep, rocky cutoff trails*).
5. Continue past exhibits 7 and 8.
6. Shortly after exhibit 8, you'll go through two short right and left switchbacks with cut off trails. Stay on main trail through the switchbacks.
7. At next "T" and exhibit 9, turn **LEFT** downhill to exhibit 10.
8. At exhibit 10, turn **AROUND** & return to exhibit 9.
9. Continue **STRAIGHT** ahead to exhibit 11.
10. Turn **LEFT** on trail toward #12-22 and pass exhibits 12 and 13 to another gravel trail junction (unmarked) on your left.
11. Continue **STRAIGHT** at junction, pass exhibits 14 and 15 to a "Y" trail junction (*small sign points to exhibits 16-22*).
12. **ANGLE RIGHT** at the "Y" on Interpretive Trail to exhibit 16.
13. At exhibit 16, turn **RIGHT** and continue uphill past exhibits 17, 18 and 19 to another "Y".
14. Turn **LEFT** at the "Y" (*small sign points to exhibits 20 -21*) and **LEFT** again at another "Y" (unmarked) shortly after that.
15. Pass exhibits 20 and 21 and continue around to the main trail junction again. On the way, you'll pass a short gravel trail on your left.
16. Turn **LEFT** on the signed "Hiking" trail and pass exhibits 16 through 19 again to a "Y".
17. This time, **ANGLE RIGHT** at the "Y" (*small signs point right to exhibit 22 and hiking trail*).
18. In 60 feet, turn **RIGHT** at the next trail junction (unmarked).
19. Proceed past exhibit 22 on the ridge top hiking trail. Once you get to the ridgetop there is a barbed wire fence on your left.
20. After the main trail makes a large, sweeping 180 degree curve to the right, turn **SHARP LEFT** at the next gravel trail junction (small hiking trail sign) and stay on the main hiking trail.
21. At the next gravel hiking trail junction, **ANGLE LEFT** and stay on the main trail.
22. At the next "Y" junction (unmarked), turn **SHARP RIGHT** on the main gravel trail. In 200 feet, the gravel trail turns to asphalt and you are at exhibit 3.
23. Stay **STRAIGHT** on the asphalt path past exhibits 2 and 1 back to the parking lot.

POC: J. Blazek 509-899-6535

Thank you for hiking our Vantage "Trees of Stone" trail.

The walk directions and maps may only be used in conjunction with a signed AVA athletic waiver. All other uses are prohibited.

© 2026 Central Washington Sun Striders 1/25/26

Page 3 of 5 walk directions and maps

- "Trees of Stone" Interpretive + Hiking Trail
- - Location number of petrified wood exhibits
- - Walking Route
- - - Other Trails

Vantage 3k →

4N

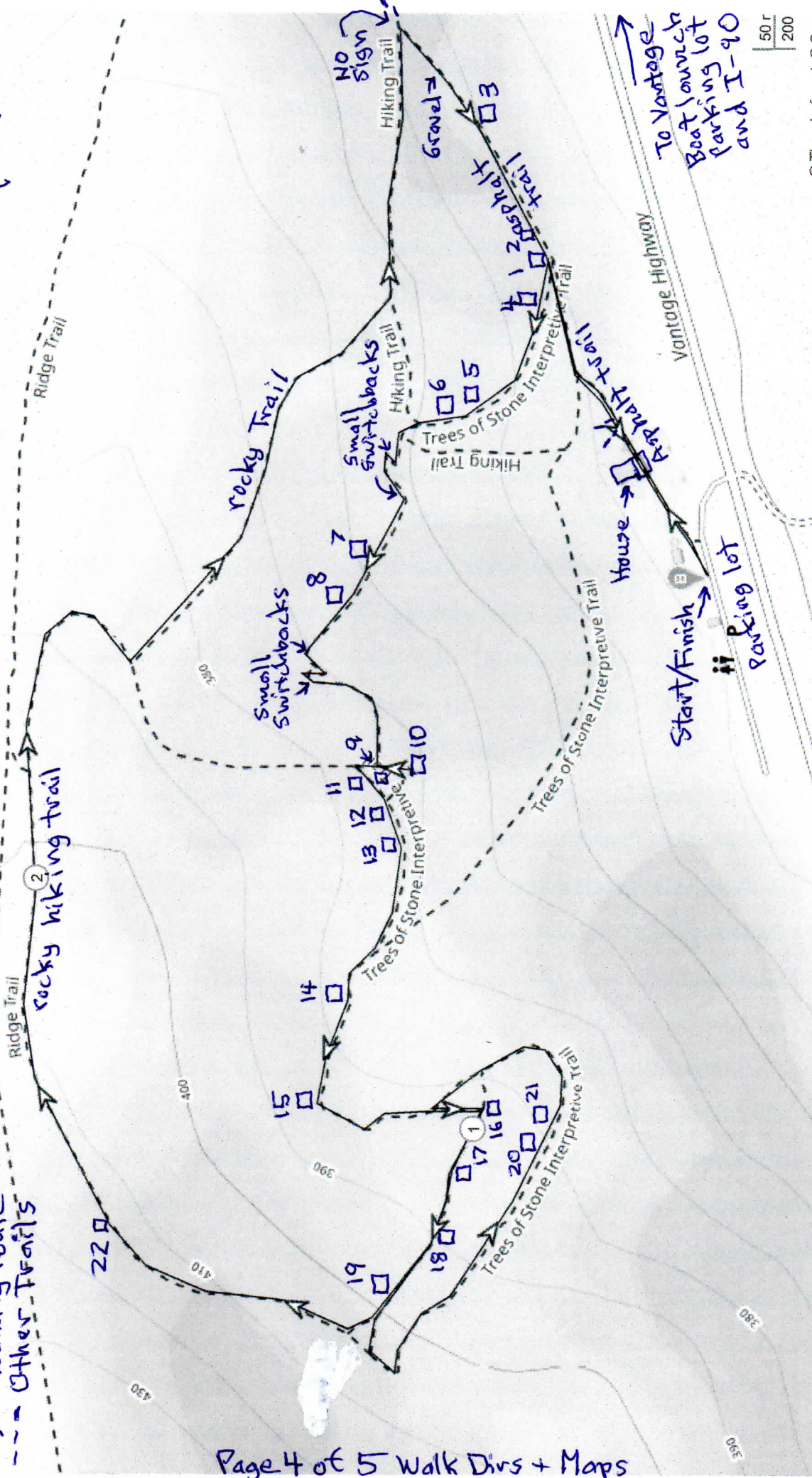

To Vantage Boat launch parking lot and I-90

Vantage Highway

Start/Finish parking lot

© Thunderforest, © OpenStreetMap

To Ellensburg

**VANTAGE - 6K PALOUSE TO CASCADES STATE PARK RAIL TRAIL Y2184
CENTRAL WASHINGTON SUN STRIDERS - 6K Rated 1B**

Driving Directions to Vantage boat launch parking lot (facilities) 46.56' 26.86" N 119.59' 07.11"W

1. On I-90, take Exit 136 (Vantage/Huntzinger Rd) to the stop sign. Turn **LEFT** toward Vantage.
2. Just past the freeway interchange, turn **RIGHT** on Boat Ramp Road and go downhill keeping to the **RIGHT** to the boat launch parking area. Park in the single vehicle parking area nearest the restroom building. If full, then park across on the other side of the parking lot or in the gravel area. Don't park in the boat trailer parking slots. Vault Toilets/porta potties available at boat launch parking lot. A porta potty is available at the gravel rail trail parking lot.

Driving Directions from Vantage boat launch parking lot to 6K walk start 46.50' 34.99"N 119.57' 50.82"W

1. Drive out Boat Ramp Road to the stop sign at Main Street (no sign).
2. Turn **LEFT** on Main Street. After crossing over I-90, Main turns into Huntzinger Rd. Drive 7 ½ miles on Huntzinger Rd.
3. Along the way, you will pass Wanapum Dam. After the dam, you will go up a small hill, curve **RIGHT** at the top of the rise, **CROSS** the railroad grade, then curve to the **LEFT**. The small gravel parking lot with a porta-potty will be on your **LEFT**. **The parking lot doesn't require a Discover Pass.** Don't leave any valuables in your car. There is no shade on this walk.

6K Walk Directions and Map for the Rail Trail Walk

If there is an emergency, call 911

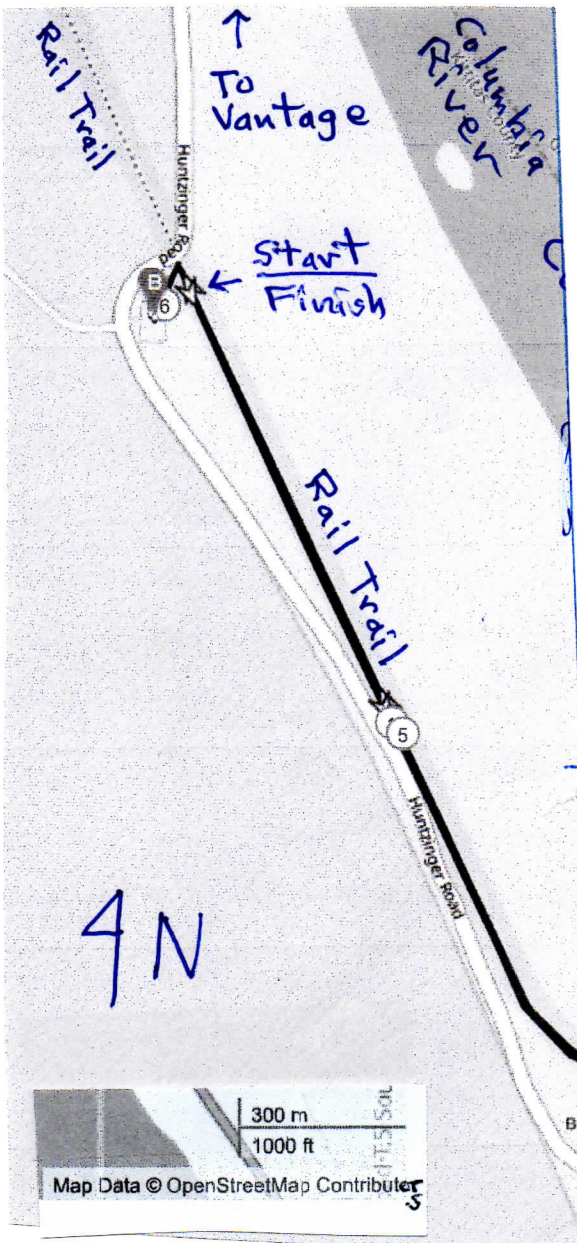

1. Facing the river in the gravel parking lot, turn **LEFT** and follow the gravel access trail to the rail trail.
2. Turn **RIGHT** on the rail trail. Follow it as it will curve to the left and go across the bridge and over the river to the east side.
3. At the far end of the bridge (east end) where you are above the highway, turn **AROUND** and return across the river and back to your vehicle.

POC: J. Blazek 509-899-6535

Thank you for walking the "Palouse to Cascades" Rail Trail.

The walk directions and map may only be used in conjunction with a signed AVA athletic waiver. All other uses are prohibited.

© 2024 Central Washington Sun Striders

Page 5 of 5 walk directions and maps



Ginkgo Petrified Forest State Park

Vantage

Walk Event Location

- Hiking
- Picnic area
- Ranger station
- Boat launch
- Parking
- Park boundary

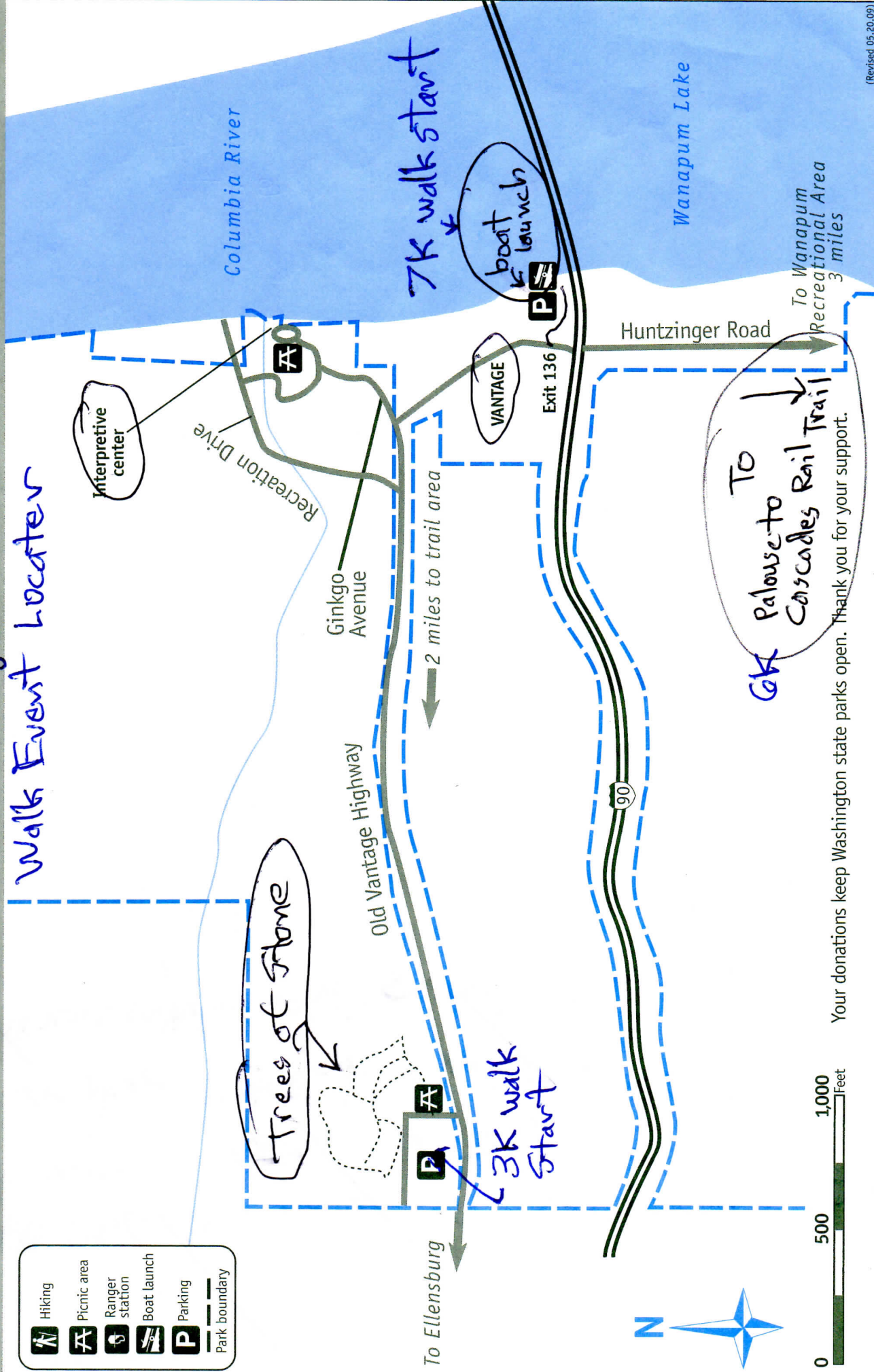

Your donations keep Washington state parks open. Thank you for your support.

4511 Huntzinger Road Vantage, WA 98950 • Information Center (360) 902-8844

(Revised 05.20.09)