

# Lake Meridian Park Walk YR2597



## 5K/10K, Rated 1A

Sea-Tac Volkssport Club welcomes you to Kent, WA

**Starting Point:** Lake Meridian Park, 14800 SE 272<sup>nd</sup> St., Kent, WA

**GPS LOCATION:** 47.358348, -122.143807

**Restrooms:** Restrooms at Start.

**Driving Directions:** SR167 NORTH/SOUTH Exit at So. 277 No. **NORTH**, TURN RIGHT on So. 277 St., RIGHT on Kent-Kangley Rd. (becomes SE 272 St.) to 148 Ave SE LEFT ON 148 Ave SE into Lake Meridian parking lot. **SOUTH**, TURN LEFT ON So. 277 St. and follow above instructions to start at Lake Meridian Park.

© 2025 Sea-Tac Volkssport Club. This map and directions may only be used in conjunction with a signed American Volkssport Association athletic waiver, all other uses are prohibited.

**Special Programs:** AVA – A-Z (K), Par for the Course, Strolling along the River (10k)

**ESVA:** King County



In case of Emergency Dial 911 State your location, Speak clearly and slowly

Please use either the Online Start Box (OSB) or Physical Start Box (PSB) to register and complete the event. Do NOT mix and match, for example, by registering using the OSB then completing your event using the PSB nor signing the PSB log sheet. The sponsoring club only receives credit for an OSB participation when an OSB registration has been completed online by entering your participation date, distances, and any special programs using the OSB.

**WALK COMPLETION AND CREDIT:** Be sure to log back into the OSB system to finish/complete your online registration after doing the event. The OSB system does not deduct any event fee from a participants Event Bank until they have submitted event completion info including the date the event was walked, the distance walked, and the selection of applicable special programs that person is participating in. Nevertheless, a fee of \$2 for a downloaded PDF is deducted from the users Event Bank when the PDF is downloaded. Later, any PDF fees are credited back to a user Event Bank when he/she submits the event completion info as a paying for credit participant. Note, however, the \$2 coupon for the downloaded PDF will expire in 60 days.

POC:

Fran Carson

206-788-7969

[fran55carson@gmail.com](mailto:fran55carson@gmail.com)

Page 1	Introduction, Info and Details
Page 2	5k/10k Directions
Page 3	5K/10k Map

# Lake Meridian Park Walk YRE #2597

5K/10K Rating 1A  
Sea-Tac Volkssport Club

**Starting Point:** Lake Meridian Park, 14800 SE 272<sup>nd</sup> St., Kent,

## **Walk start at the left cul-de-sac.**

1. Enter the sidewalk at 3 white posts and white fire hydrant on right.
  2. **LEFT** at third Y on the sidewalk (Wisteria vined rotunda on right)
  3. **STAY LEFT** on path toward the pier and onto the left metal/wood pier going to the end (beside the lifeguard's chair during swimming season).
  4. **TURN AROUND, LEFT TURN** at cross pier to next pier and **TURN LEFT** to the end of this pier.
  5. **TURN AROUND**, leaving the pier returning to the beach area.
  6. **DIAGONAL RIGHT** toward steps and up steps to the Wisteria vined rotunda (restrooms). Keep rotunda on left. Stay on the sidewalk and circle to your right. Then left toward the parking lot.
  7. **LEFT** at the car cul-se-sac, staying on the sidewalk.
  8. **LEFT** at white/yellow post, **IMMEDIATE RIGHT**. A ring of grass/lawn mounds will be on right.
  9. **LEFT** at the Y, mounded ring now on left.
  10. **RIGHT** at sidewalk (children's climbing web visible in the distance).
  11. **RIGHT** on sidewalk (between covered picnic tables and children's playground toys)
  12. Continue walking toward the lake, then down steps walking on the grass toward concrete park bench.
  13. Walk to the right near the water's edge, staying on the grass (between you and lake is grass and a small strip of sand).
  14. Follow grass to the right. A line of shrubs, trees will be on left. Stay on grass with shrubs and trees on left.
  15. **LEFT**, walking to end of the boat launch to a blue sign "Boating Rules". (wait for oaters to finish launching boats before walking to the end of the pier).
  16. **TURN AROUND**, walk to the stop sign.
  17. **LEFT** at 148 Ave. SE,
  18. **LEFT** on SE 267 St.
  19. At stop sign, **LEFT** on SE 266 St. **LEFT** at Y to stay on SE 266 St. (it meanders).
  20. Pass "Private Property Meridian Manor HOA sign, follow the curve to be on 142 SE (sign for intersection of SE 264 and 142 SE).
  21. At stop sign, **CROSS** to the opposite side of 142 SE ST. (Do not walk on SE 260 St.) Walk on 142 St. SE. Street curves left.
  22. **LEFT** on 143 Ave. SE. The street curves and becomes SE 262 St.
  23. **LEFT** and **CROSS** 144 Ave. SE.
  24. **RIGHT** on SE 261 St.
  25. **RIGHT** on 145 Ave. SE.
  26. **RIGHT** 147 Ave. SE
  27. **LEFT** on SE 263 St. Continue walking past the "Soos Creek Park and Trail" Sign. The road meanders becoming 148 Ave. SE.
  28. **10 walkers use directions in box, begin with #29 after exiting Soos Creek Park. 5K walkers continue to directions #29**
- 10K WALKERS** Porta-Potty on left at trailhead  
A – **LEFT** AT Soos Creek Park and Trail sign, entering park to the walk on the trail.  
B – **CROSS** unmarked SE 256 St. (first street),  
C – Continue on the trail.  
D – **RIGHT** at Y in rail (sign left to restrooms).  
E – **TURN AROUND** at second street (unmarked So. 240 St.) returning on trail.  
F – Walk on **LEFT SIDE OF ROCK** with monument sign to Giant Sequoia (rest room sign on right).  
G – **CONTINUE** back to Soos Creek Park Trail head  
H – **EXIT** Park and **LEFT** at unmarked 148 Ave. SE
29. Pass the street sign on left at 149 Ave SSE. Use light and crosswalk to walk on opposite side of unmarked 148 Ave. SE.
  30. Enter Lake Meridian Park at sidewalk (no sign). Stay on sidewalk (barbeque grills on your right during summer months)
  31. Continue on the sidewalk into the mail park.
  32. **LEFT** at red trash box, dog bag station and barbeque grill.
  33. **RIGHT** on the sidewalk at T toward child play area.
  34. Continue around right of grass/lawn mounds on left until you reach the parking lot and your car.

Thank you for walking our Kent Lake Meridian Park Walk.

Contact person: Fran Carson

206-788-7969 [fran55carson@gmail.com](mailto:fran55carson@gmail.com)

Copyright ©2025 Sea-Tac Volkssport Club. These walk directions and maps may only be used in conjunction with a signed American Volkssport Association athletic waiver. All other uses are prohibited.

**For Emergency Help: Call 911 State your location, speak clearly and slowly.**

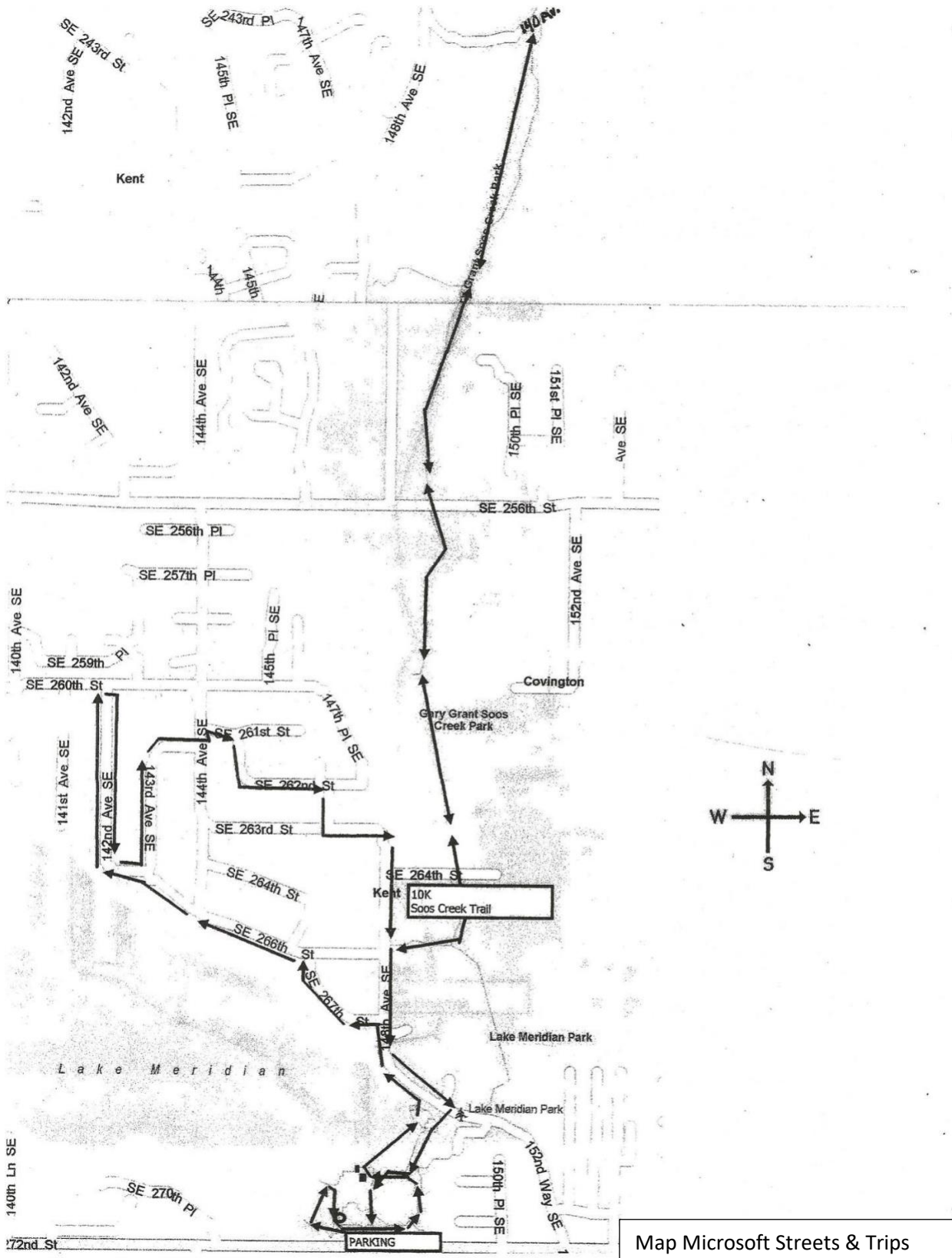

Map Microsoft Streets & Trips