

**WELCOME TO THE
SELAH TOWN AND PARKS - YEAR ROUND WALK - Y3169**
Yakima County, Washington 6K rated 1A 10K rated 2A Central Washington Sun Striders

This On-line Start Box packet contains the following 4 pages of information:

1. This Welcome page with Driving Directions and Supplemental Info for this event (1 page).
2. Walk directions for both 6K and 10K (1 page).
3. A map for the 6K (1 page).
4. A map for the 10K (1 page).

Driving Directions to the Walk Start

This walk event starts at the Selah Civic Center - 216 South 1st Street, Selah, WA. 98942.
N 46 degrees 39'03.13" W 120 degrees 31'51.61"

WestBound (going north) on I-82: Get in the left lane of I-82 to take Exit 30A to Selah. Exit onto North SR 823. SR 823 will become South 1st Street in Selah. One block past the Valleyview Ave/Jim Clements Way stoplight, turn LEFT on Selah Avenue and immediately turn RIGHT into the Civic Center parking lot.

EastBound (going south) on I-82: Take Exit 26 to Selah. At the stop sign, turn RIGHT (North) on SR 821. In a short distance, turn LEFT (South) on SR 823 (Harrison Rd) toward Selah. At the "T", turn LEFT (South) on SR 823 toward Selah. In Selah, SR 823 changes names to N. Wenas Road and then to Jim Clements Way. At the stop light at S. First Street, turn RIGHT on S. First Street and in one block, turn LEFT on Selah Avenue and immediately turn RIGHT into the Selah Civic Center parking lot.

Supplemental Information

Restrooms are available at the civic center from 8am to 5pm Monday through Friday. Other restrooms are available at fast food restaurants and coffee shops along 1st Street and at Volunteer Park along the walk route. If you walk this event during the winter months, sidewalks may be icy in the morning. The 6K has one small hill that you go up and down and the 10K has two hills to go up and down.

Event Disclaimer: These walk directions and maps may only be used in conjunction with a signed American Volkssport Association athletic waiver. All other uses are prohibited.

SELAH - Town and Parks - YRE 3169
Central Washington Sun Striders
Yakima Co. 6K rated 1A 10K rated 2A

Both 6K and 10K start the same

1. Facing 1st St in front of the civic center, Turn **LEFT**.
2. At Park Ave, Turn **RIGHT** and cross 1st Street.
3. Turn **LEFT** and **CROSS** Park Ave. Continue on 1st.
4. **CROSS** 2nd Ave and turn **RIGHT** on 2nd Ave.
5. Turn **LEFT** on Jim Clements Way.
6. Clements Way **ANGLES RIGHT** and becomes North Wenas Road. **CONTINUE** on N Wenas Rd.
7. Turn **LEFT** on Goodlander Road.
8. **CROSS** North 1st Street.
9. **6K walkers turn LEFT on 1st Street. Then skip to instruction # 14.**
10. **10K walkers continue STRAIGHT ahead on Goodlander Road and continue with # 11.**
11. Turn **LEFT** on North 4th Street.
12. Turn **LEFT** on Palmer Drive.
13. Turn **RIGHT** on N. 1st Street. (1st St. is unsigned)
14. Turn **RIGHT** on Merinda Drive.
15. Angle **LEFT** into Volunteer Park.
16. Angle **RIGHT** behind the restrooms on the asphalt path and circle the park on the path.
17. Leaving the park, angle **RIGHT** and down hill back on Merinda Drive.
18. Turn **RIGHT** on 1st Street (no street sign for 1st).
19. Turn **RIGHT** on Fremont Ave. (small street sign on left).
20. Carefully **CROSS** N. 4th St.
21. Carefully **CROSS** Speyers Rd (no street sign) and immediately turn **RIGHT** into small American Legion Park plaza.
22. Turn **AROUND** and return to Fremont Ave.
23. Turn **LEFT** on Fremont Ave and in 30 feet, turn **RIGHT** and carefully **CROSS** Fremont Ave in the first crosswalk you come to.
24. Turn **LEFT** on Fremont Ave and in 150 feet, turn **RIGHT** and walk on the paved walking path.
25. **6K walkers turn LEFT on W. Naches Ave (no sign).**
Then do instructions # 26 - #28.
10K walkers turn RIGHT on W. Naches Ave (no sign).
Then skip to and do instructions # 29 - #41.

If there is an emergency, dial 911.

26. **CONTINUE** on W. Naches Ave to Selah City Hall at 115 W. Naches Ave. Turn **AROUND** and return one block on W. Naches Ave to South 3rd St (no street sign but has an overhead School Crossing sign).
27. Turn **LEFT** on South 3rd Street.
28. Turn **LEFT** on Selah Ave back to the Civic Center.
29. **10K walkers,** At intersection of Hillcrest Dr, stay **STRAIGHT** on Crusher Canyon Rd. It will go uphill and curve to the left.
30. Turn **LEFT** and carefully **CROSS** Crusher Canyon Rd at S. 10th St (no crosswalk) and continue uphill on 10th St
31. Turn **LEFT** on West Seventh Ave.
32. Turn **LEFT** at the "T" which is Hillcrest Dr. (unsigned). *Enjoy the view of Selah from Palm Park.*
33. Turn **RIGHT** on Crusher Canyon Rd.
34. It will change to W. Naches Ave. Walk to Selah City Hall at 115 W. Naches Ave (on left side of street).
35. Turn **AROUND** and return one block on W. Naches Ave to South 3rd Street (no street sign but has an overhead School Crossing sign)
36. Turn **LEFT** on South 3rd Street.
37. Turn **RIGHT** on Selah Ave to the street end. *(Restrooms in Wixon Park).*
38. Turn **AROUND** and return to S. 3rd St (unsigned).
39. Turn **RIGHT** on South 3rd Street.
40. Turn **LEFT** on Valleyview Ave.
41. Turn **LEFT** on S. 1st St. back to the civic center.

We hope you enjoyed our Selah walking event.
POC: J. Blazek joeblazek1@gmail.com

Be sure to log back into the OSB system (my.ava.org) to finish/complete your online registration after doing the event. The OSB system does not deduct any fee from an event bank until they have submitted event completion info including the date the event was walked, the distance walked, and the selection of applicable special programs that walker is participating in. (Nevertheless, a fee of \$2 for a downloaded pdf is deducted from the user's Event Bank when the pdf is downloaded. Later, any pdf fees are credited back to a walker's Event Bank when he/she submits the event completion info as a paying for credit walker.) The \$2 "coupon" for the downloaded pdf expires in 60 days.

Selah 6K

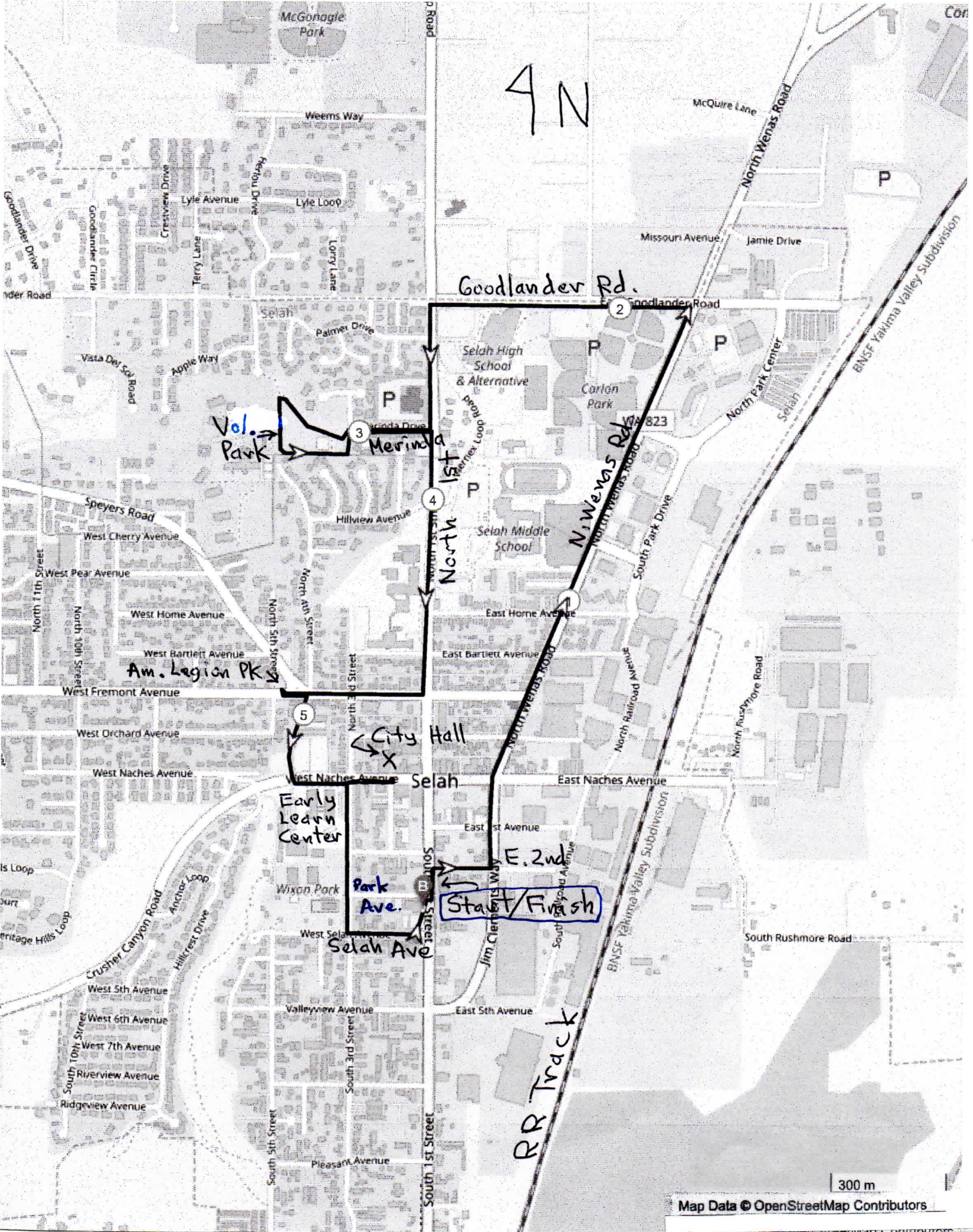

Selah 10K

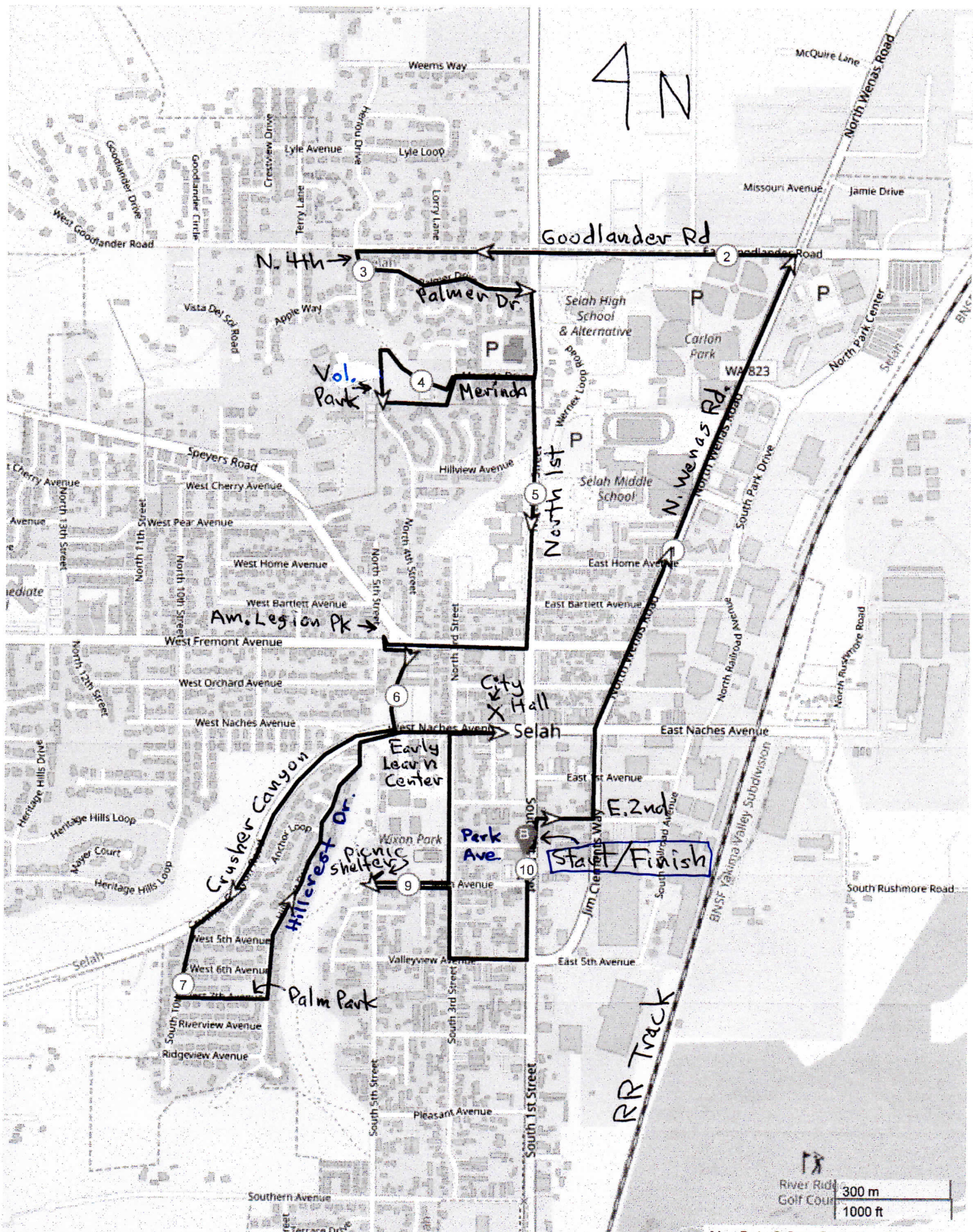

4 N

Goodlander Rd

Vol. Park

Am. Legion Pk

City X Hall

Start/Finish

RR Track

300 m
1000 ft

Map Data © OpenStreetMap Contributors