

2020 NEWPORT SEASONAL WALK

Driving Directions to Start Point

Start Point Address:
Newport Community Hospital
714 W. Pine Street
Newport, WA 99156

Directions from Spokane:

North on US 2 to Newport.
Left on 1st Street to Scott.
Right on Scott to Hospital.
Park away from the building.

NOTE: Currently there is not a Physical Start Box at this location. Water and Restrooms not available in the Colville National Forest portion of the walk. City Parks have restrooms, if open.

2020 NEWPORT TOWN AND WOLF TRAIL WALK
10 K INSTRUCTIONS RATED 2B
SE 0989/SANCTION # 114695

©2020 by the Lilac City Volkssport Association

These walk directions and maps may only be used in conjunction with a signed American Volkssport Association athletic waiver. All other uses are prohibited.

EMERGENCY: CALL 911

POC: George and Donna Withers, (509) 624-6518

Directions are from the Hospital door.

1. **EXIT** Hospital to Scott
2. **LEFT** on Scott to Spruce
3. **LEFT** on Spruce to Cass
4. **RIGHT** and Cross Spruce and continue on Cass to Fea
5. **RIGHT** on Fea to Larch/Laurelhurst
6. **LEFT** on Laurelhurst to Upper Wolf Trail Parking Lot on Left (1K)
7. **WALK THROUGH** parking lot and enter Alpha Loop to trail
8. **LEFT** on trail back to the parking lot (2K)
9. **CROSS** parking lot and Laurelhurst
10. **ENTER** Upper Wolf Trail to intersection (Upper Wolf Trail Walkers stay left. Keep the road on your left and the wilderness area on your right)
11. **TAKE LEFT** trail (Howler/Arctic Trail if signs are up)
12. **STAY LEFT** Take Arctic Trail
13. **STAY LEFT** at Lone Wolf Trail Sign (3K at Power Pole #30)
14. **STAY LEFT** Take Howler Trail
15. **STAY LEFT** Take Scapegoat to Lower Wolf Trail Sign (4K)
16. **LEFT** down the hill to WSH 20.
17. **CROSS** WSH 20
18. **ENTER** Lower Wolf to intersection and bench
19. **TURN LEFT** to "Y" (Lower Wolf Trail walkers stay left. Keep the roads on your left and the wilderness on your right)
20. **TAKE LEFT** trail to intersection 305/304 and bench (5K)
21. **TAKE LEFT** trail to Viewpoint
22. **CONTINUE** on trail. (AT EACH INTERSECTION TAKE LEFT TRAIL)
23. **WALK THE LOOP** back to intersection 305/304 (6K)
24. **TURN LEFT** and continue down the hill past the Lower Wolf parking lot
25. **STAY LEFT** to the "T"
26. **LEFT** and exit Wolf Trails onto WARREN
27. **CROSS** Warren
28. **RIGHT** on Warren to Larch
29. **LEFT** on Larch to Washington
30. **RIGHT** on Washington to US 2
31. **CROSS** US2
32. **CONTINUE** on Washington to 1st Ave
33. **LEFT** on 1st Ave to Union
34. **RIGHT** on Union to 4th Ave

35. **RIGHT** on 4th Ave (Museum across 4th Ave) to Scott (Courthouse on corner of 4th and Scott)
36. **RIGHT** on Scott to Newport Community Hospital

REMINDER: *Log back into the OSB System to finish/complete your online registration by entering participation date, distances, and any special programs after completing this event.*

The Lilac City Volkssport Association and Newport Community Hospital hope you enjoyed your experience and will come again.

2020 Newport Town and Wolf Trail

10K

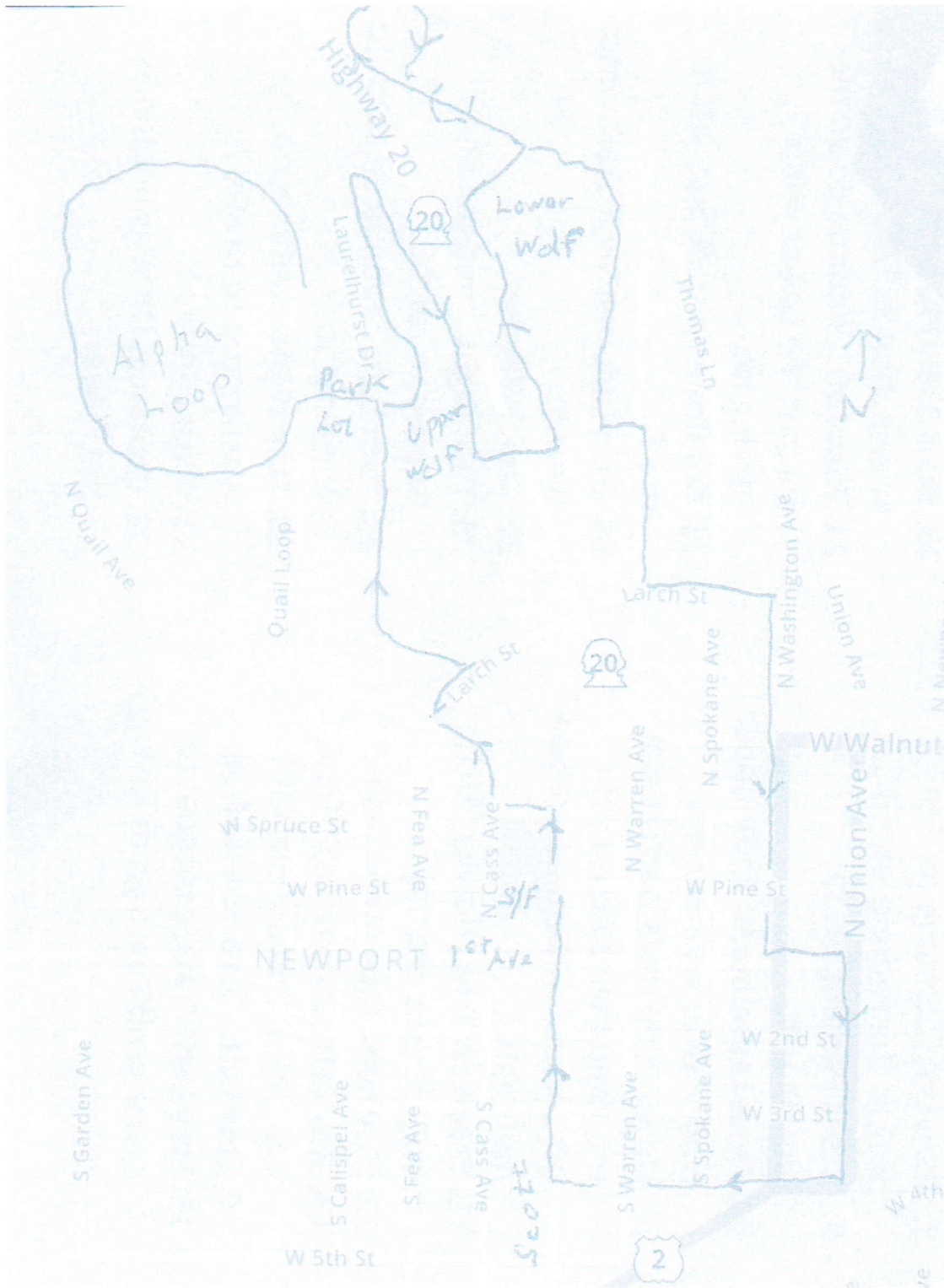

2020 NEWPORT TOWN AND WOLF TRAIL WALK
5K INSTRUCTIONS RATED 2B
SE 0989/SANCTION # 114695

©2020 by the Lilac City Volkssport Association

These walk directions and maps may only be used in conjunction with a signed American Volkssport Association athletic waiver. All other uses are prohibited.

EMERGENCY: CALL 911

POC: George and Donna Withers, (509) 624-6518

Directions are from the Hospital door.

1. **EXIT** Hospital to Scott
2. **LEFT** on Scott to Spruce
3. **RIGHT** on Spruce to Warren
4. **LEFT** on Warren to WSH 20
5. **CROSS** WSH 20
6. **CONTINUE** on Warren to Wolf Trail entrance (about 50 feet past Ash St)
7. **TRAIL** on **LEFT** side of Warren
8. **LEFT** on trail to intersection and bench
9. **STAY LEFT** continue on trail to Hiway intersection.
10. **CONTINUE STRAIGHT** past the bench to the "Y"
11. **TAKE LEFT** trail to intersection 305/304 and bench
12. **TAKE LEFT** trail to Viewpoint
13. **CONTINUE** on trail. (AT EACH INTERSECTION TAKE LEFT TRAIL)
14. **WALK THE LOOP** back to intersection 305/304
15. **TURN LEFT** and continue down the hill past the Lower Wolf parking lot
16. **STAY LEFT** to the "T"
17. **LEFT** and exit Wolf Trails onto WARREN
18. **CROSS** Warren
19. **RIGHT** on Warren to Larch
20. **LEFT** on Larch to Washington
21. **RIGHT** on Washington to 1st Ave
22. **LEFT** on 1st Ave to Union
23. **RIGHT** on Union to 4th Ave
24. **RIGHT** on 4th Ave to Scott
(Courthouse on corner of 4th and Scott)
25. **RIGHT** on Scott to Newport Community Hospital

REMINDER: *Log back into the OSB System to finish/complete your online registration by entering participation date, distances, and any special programs after completing this event.*

The Lilac City Volkssport Association and Newport Community Hospital hope you enjoyed your experience and will come again.

**2020 NEWPORT TOWN WALK
5K INSTRUCTIONS RATED 1A
SE 0989/SANCTION # 114695**

©2020 by the Lilac City Volkssport Association

These walk directions and maps may only be used in conjunction with a signed American Volkssport Association athletic waiver. All other uses are prohibited.

EMERGENCY: CALL 911

POC: George and Donna Withers, (509) 624-6518

Directions are from the Hospital door.

1. **EXIT** Hospital to Scott and Cross
2. **RIGHT** on Scott to 1st Ave
3. **LEFT** on 1st to Union
4. **RIGHT** cross 1st and stay on Union to 4th
5. **RIGHT** on 4th to Washington (1K) Museum across 4th
6. **CROSS** Washington
7. **RIGHT** on Washington to Spruce
8. **LEFT** on Spruce to Cass Ave. (2K)
9. **RIGHT** on Cass Ave as it curves and intersects with Fea/Larch
10. **LEFT** on Fea Spruce and cross
11. **RIGHT** on Spruce to Calispel
12. **Cross** Calispel and continue on Spruce (dirt road) to Craig
13. **LEFT** on Craig to 1st Ave.
14. **CROSS** 1st Ave. and enter park on gravel road (Restrooms in the park) (3K)
15. **EXIT** park on Calispel
16. **RIGHT** on Calispel to 5th Ave
17. **LEFT** on 5th Ave to Warren St.
18. **LEFT** on Warren to 4th Ave
19. **LEFT** on 4th Ave. to Scott and cross (Courthouse on corner of 4th and Scott) (4K)

20. **RIGHT** on Scott to Newport Community Hospital

REMINDER: *Log back into the OSB System to finish/complete your online registration by entering participation date, distances, and any special programs after completing this event.*

The Lilac City Volkssport Association and Newport Community Hospital hope you enjoyed your experience and will come again.

2020 Newport Town Walk

5K

