

INSTRUCTIONS RUFUS, Oregon 5/10 km walks

Sherman County

5 KM and 10 KM Rated 1A – Stamp # Y1403

Walk Start Location: 5 KM Only – Across from the Sinclair Gas Station at 501 SE 1st, Rufus, OR
10 KM Only – Starts at John Day Dam

GPS Coords: 45.69484, -120.7359

Restrooms available at Start (5 km use the Sinclair Station – 10 km use the restrooms at the boat ramps.)

DRIVING DIRECTIONS: East bound take I-84 East to Exit 109 at Stop Sign. 5km walkers turn LEFT then LEFT on E 1st St. West bound take I-84 to Exit 109 at Stop sign. 5km walkers turn RIGHT then LEFT on E 1st St. NOTE: 5km walkers will start across E 1st St from the Sinclair Gas Station. There is a truck parking area here to park your car in the City of Rufus. NOTE: 10km walkers start at the John Day Dam (follow signs to Dam from Exit 109)

PARK: 5 KM Use truck parking in City of Rufus. 10KM use parking lot at the dam.

Walk completion and Credit: Be sure to log back into the OSB to finish/complete your online registration after doing the event. The OSB system does not deduct any event fee from a participant's Event Bank until they have submitted event completion info including the event was walked, the distance walked, and the selection of applicable special programs that person is participating in. (Nevertheless, a fee of \$2 for a download PDF is deducted from the user's Event Bank when the PDF is downloaded. Later, any PDF fees are credited back to a user's Event Bank when he/she submits the event completion info as a paying for credit participant. Note, however, the \$2 coupon for the downloaded PDF will expire in 60 days).

RUFUS

Sherman County

5 KM Rated 1A

These walking instructions and maps may only be used in conjunction with a signed American Volkssport Association athletic waiver. All other uses are prohibited. For emergencies: contact 911. Walk owner is Martha Korff and she can be reached at 503-369-9906.

| | |
|---|---|
| <ol style="list-style-type: none">1. Facing the front of the Sinclair Gas Station on E 1st turn RIGHT to walk under I-84 Note: this is the same road you came off the freeway on2. RIGHT toward I-84 to walk under I-84 to John Day Dam Lane3. CROSS then RIGHT on John Day Dam Lane (no sign) to Giles French Park sign4. Just in case the Giles French Park sign is down, it will be the 2d road on your left. (The first road left has a gate and is the Native American's boat storage and boat ramp. LEFT at the Giles French Park sign to the restrooms (1.5 km)5. At the restroom stay LEFT and continue on through the parking lot to the boat ramp6. RIGHT to the bottom of the boat ramp is a Lewis and Clark plaque under solar power light pole.7. Turn around and keep LEFT back to the restroom8. Slight RIGHT at the restrooms to follow the road out to John Day Dam Lane9. RIGHT on John Day Dam Lane (no sign) to Freeway entrance road10. LEFT on road that leads to freeway (no sign) to City of Rufus (2.6 km) | <ol style="list-style-type: none">11. Walk under the freeway to City of Rufus then RIGHT on E 1st St to RV Park sign (3 km)12. At RV Park sign/Speed 35 as well, LEFT to CROSS E 1st St then slight RIGHT on W 2d St to Old High School/City Hall13. On W 2d St is the Old Rufus High School/City Hall CIRCLE the flag pole and return back to W 2d St to Wallace St14. RIGHT on Wallace St to W 3d St15. LEFT ON w 3D St to Main St (4 km)16. LEFT on Main St (no sign). This is a busy street. (Many grain trucks and traffic)17. At Main St RIGHT to CROSS Main St then RIGHT on Main St. (Walking on the opposite side of Main St now) to E 3d St18. LEFT on E 3d St to Fowler St (passing the Post Office on your right up the hill19. LEFT on Fowler St to E 2d St20. RIGHT ON e 2D St to E 1st St21. RIGHT on E 1st St (no sign) to Freeway sign The Dalles/Pendleton22. At The Dalles/Pendleton Freeway sign continue to the Sinclair Gas Station and Finish |
|---|---|

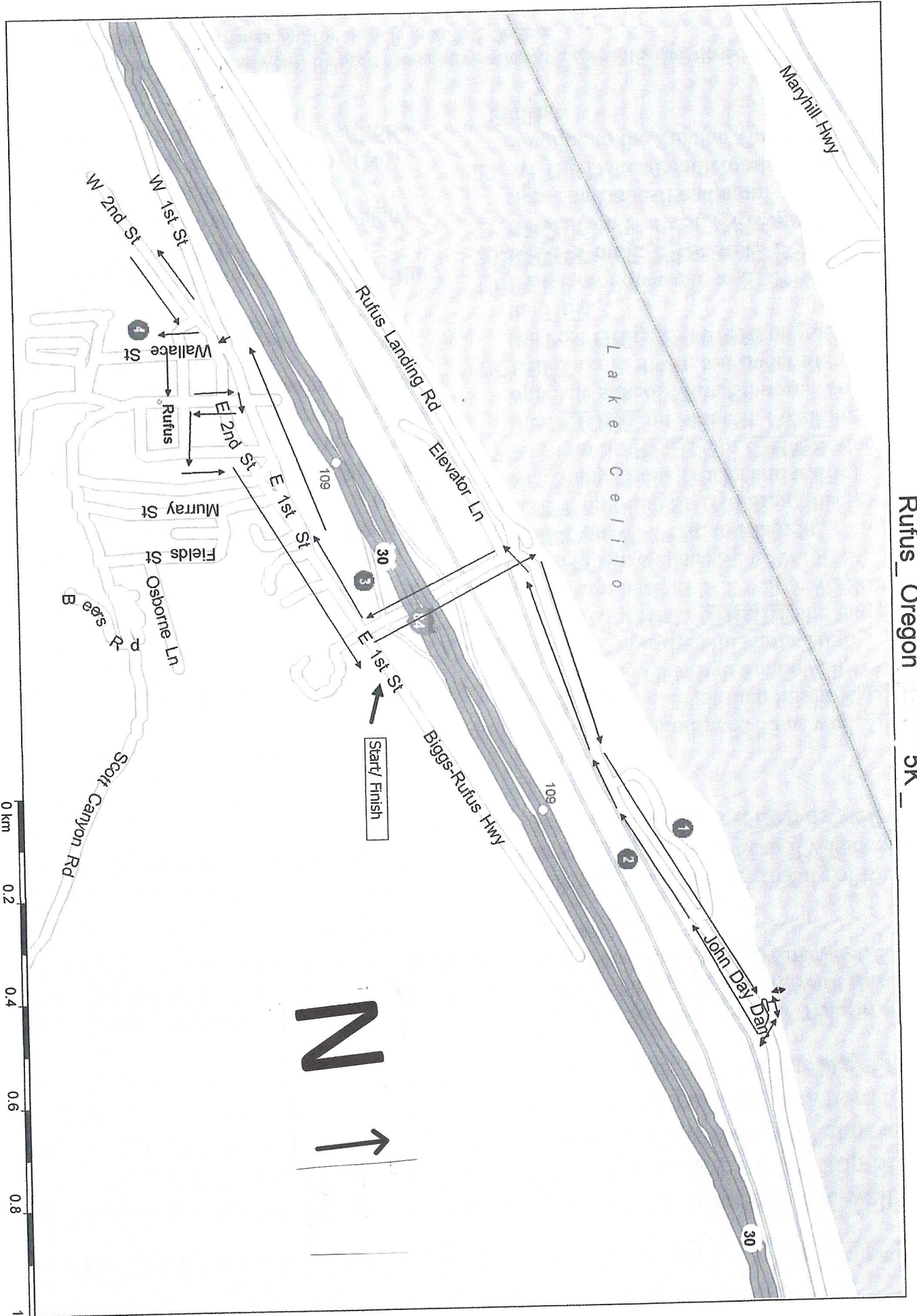

Copyright © and (P), 1988-2012 Microsoft Corporation and/or its suppliers. All rights reserved. <http://www.microsoft.com/streets/>
Certain mapping and direction data © 2012 NAVTEQ. All rights reserved. The Data for areas of Canada includes information taken with permission from Canadian authorities, including: © Her Majesty the Queen in Right of Canada, © Queen's Printer for
Ontario, NAVTEQ and NAVTEQ ON BOARD are trademarks of NAVTEQ. © 2012 Tele Atlas North America, Inc. All rights reserved. Tele Atlas and Tele Atlas North America are trademarks of Tele Atlas, Inc. © 2012 by Applied Geographic Solutions. All
rights reserved. Portions © Copyright 2012 by Woodall Publications Corp. All rights reserved.

RUFUS

Sherman County

10 KM Rated 1A

These walking instructions and maps may only be used in conjunction with a signed American Volkssport Association athletic waiver. All other uses are prohibited. For emergencies: contact 911. Walk owner is Martha Korff and she can be reached at 503-369-9906.

- | | |
|---|---|
| <ol style="list-style-type: none">1. Take the paved path from the restroom of the LEFT. NOTE: You may take any of the pathways keeping the Columbia River on your right. Some paths go to a parking lot. Just walk through the parking lot until you reach a restroom/boat ramp and parking lot. WATCH for Native American fishing platforms along the river bank for the first 2 ½ km.2. At the restroom, stay RIGHT and continue on through the parking lot to the boat ramp (2 km)3. RIGHT to the bottom of the boat ramp is a Lewis and Clark plaque under solar power light pole.4. Turn around and keep LEFT back to the restroom5. Slight RIGHT at the restroom to follow the road out to John Day Dam Lane6. RIGHT on John Day Dam Lane (no sign) to freeway entrance road7. LEFT on road that leads to freeway (no sign) to City of Rufus (3 km)8. Walk under the freeway to City of Rufus then RIGHT on E 1st St to RV Park sign9. At RV Park sign/Speed 35 as well, LEFT to CROSS E 1st St then slight RIGHT on W 2d St to Old High School/City Hall | <ol style="list-style-type: none">10. On W 2d St is the Old Rufus High School/City Hall. CIRCLE the flag pole and return to W 2d St to Wallace St11. RIGHT on Wallace to W 3d St12. LEFT on W 3d St to Main St (5 km)13. LEFT on Main St (no sign). There is a busy street14. At Main St RIGHT to CROSS Main St then RIGHT on Main St (walking on the opposite side of Main St) to E 3d St15. LEFT on E 3d St to Fowler St (passing Post Office on your right up the hill)16. LEFT on Fowler St to E 2d St17. RIGHT on E 2d St to freeway sign The Dalles/Pendleton18. At The Dalles/Pendleton freeway sign, turn LEFT to walk under the freeway to John Day Dam Lane19. RIGHT on John Day Dam Lane (no sign) to Giles French Park sign (6 km)20. At Giles French Park sign, turn LEFT and stay LEFT. Head toward the restrooms again (7 km)21. At the restrooms, RIGHT back on the trail22. On the Trail and once again it does not matter which trail you take, just keep the River on your left. Some trails will lead you back through the next parking lot. Continue to the restrooms and Finish |
|---|---|

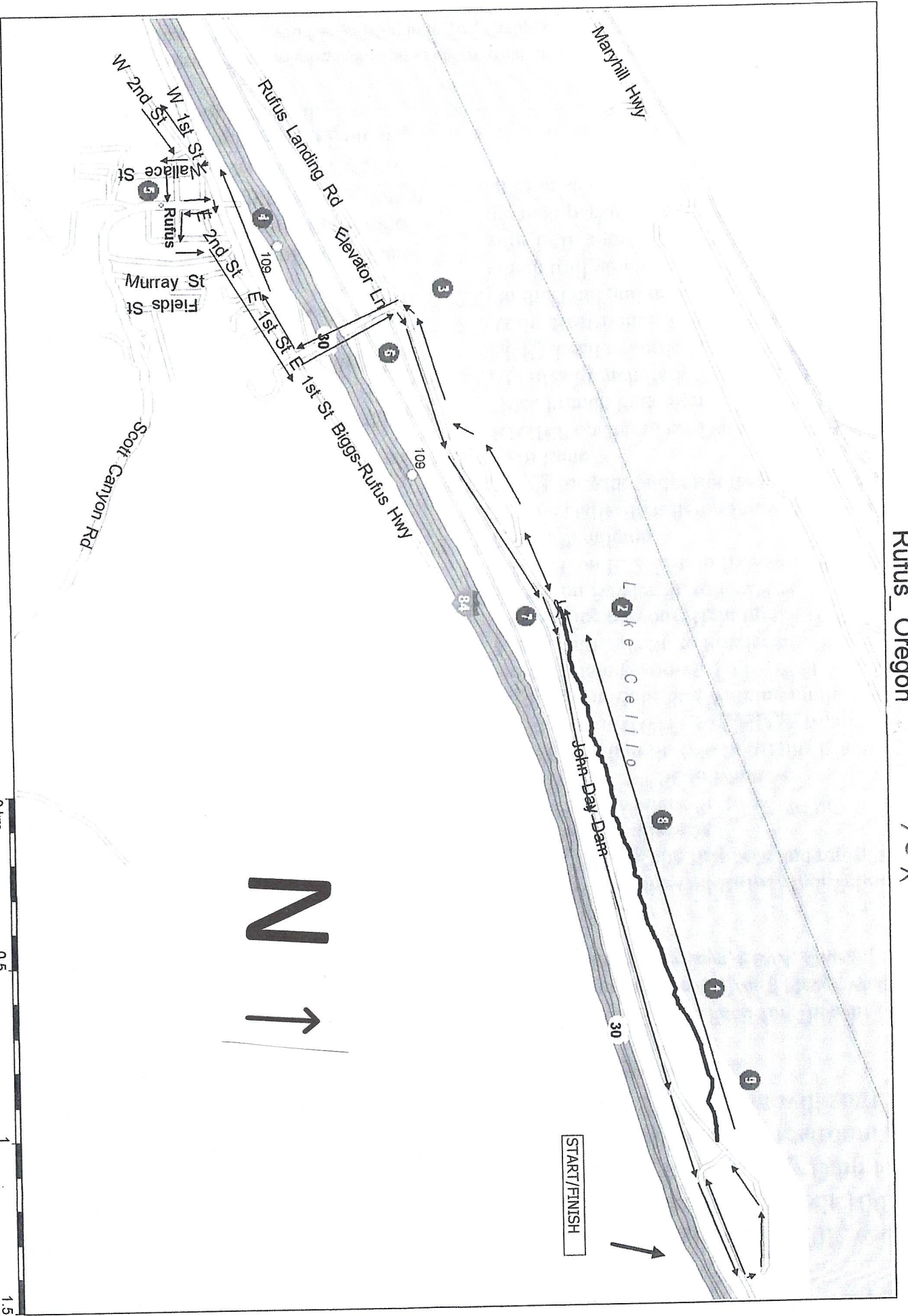

Copyright © and (P) 1988-2012 Microsoft Corporation and/or its suppliers. All rights reserved. <http://www.microsoft.com/streets/>
 Certain mapping and direction data © 2012 NAVTEQ. All rights reserved. The Data for areas of Canada includes information taken with permission from Canadian authorities, including © Her Majesty the Queen in Right of Canada, © Queen's Printer for
 Ontario, NAVTEQ and NAVTEQ ON BOARD are trademarks of NAVTEQ. © 2012 Tele Atlas North America, Inc. All rights reserved. Tele Atlas and Tele Atlas North America are trademarks of Tele Atlas, Inc. © 2012 by Applied Geographic Solutions. All
 rights reserved. P-rtions © Copyright 2012 by Woodall Publications Corp. All rights reserved.