

WASHINGTON, MO 5K YRE 1408 WALK DIRECTIONS (OSB) (RATING 2A)

COPYRIGHT © 2020 – South Central Region, AVA: America's Walking Club

This map and directions may only be used in conjunction with a signed American Volkssport Association (AVA) athletic waiver. All other uses are prohibited. In case of emergency: Dial 911

Driving directions to start point at Amtrak Train Station, 301 W. Front St., Washington, Missouri, 63090. (GPS: 38.561600,-91.012500) **From I-44 Exit #251**, go west on Hwy. 100 for 10 miles to Washington. Turn right on Hwy. 47, left on 5th St., right on Jefferson St., left on W. Front St. to # 301. **From I-70 Exit #193**, go south on Hwy. 47 for 25 miles to Washington. Turn right on 5th St., right on Jefferson St., left on W. Front St. to # 301. **From I-64/Hwy 40 Exit #10**, go west on Hwy. 94, then left on Hwy. 47 to Washington. Turn right on 5th St., right on Jefferson St., left on W. Front St. to # 301. Free parking on Amtrak parking lot, Oak and Front Streets, across the street from train station. Rest rooms in train station and on the trail.

NOTE: Please use **EITHER** the Online Start Box (**OSB**) **OR** the Physical Start Box (**PSB**) to register and complete this event. Do NOT mix and match, for example, by registering using the OSB then completing your event using the PSB and/or signing the PSB log sheet. The sponsoring club only receives credit for an OSB participation when an OSB registration has been completed online by entering your participation date, distances, and any special programs using the OSB.

OSB COMPLETION AND CREDIT: Be sure to log back into the OSB system to “finish/complete” your online registration after doing the event. The OSB system does not deduct any event fee from a participant's Event Bank until they have submitted event completion info including the date of the event, the distance, and the selection of applicable special programs that person is participating in. (Nevertheless, a fee of \$2 for a downloaded PDF is deducted from the user's Event Bank when the PDF is downloaded. Later, any PDF fees are credited back to a user's Event Bank when he/she submits the event completion info as a paying for credit participant. Note, however, the \$2 coupon for the downloaded PDF will expire in 60 days.)

Special Programs: Ice Cream Parlors; Little Free Libraries (in Amtrak Station); Rockin' Around the Clock; Walking Missouri Counties (Franklin County)

Legend: TR = Turn Right, TL = Turn Left, SA = Straight Ahead, CR = Cross, SP = Special Program Qualifier

1. **EXIT** Amtrak Depot, **TR** on **FRONT ST.** for 2 blocks to **OLIVE ST.** passing Missouri Meerschaum Co. at 400 Front St. (where corncob pipes are made).
2. **TL** on **OLIVE ST.** until it ends at Horn St.
3. **TL** on **HORN ST.** for a short block to Dubois St.
4. **TR** on **DUBOIS ST.** for 2 blocks to 5th St. [**1K**]
5. **TL** on **5TH ST.** for 8 blocks to **LOCUST ST.**, passing Immanuel Lutheran Church at 214 W. 5th St. and Saint Peter's United Church of Christ at 20 E. 5th St. You will also pass the Washington Public Library (**RESTROOMS**) on 5th Street between Lafayette and Jefferson Streets. NOTE: The library entrance is off Lafayette St., on the north side of the building.
6. **TL** on **LOCUST ST.** 4 blocks to **MAIN ST.** [**2K**, at 3rd. St]
7. **TL** on **MAIN ST.** 1 block to **WALNUT ST.**
8. **TL** on **WALNUT ST.** 3 blocks to **4TH ST.**
9. **TR** on **4TH ST.** 1 block to **MARKET ST.**, passing the old Washington Presbyterian Church, now the Washington Historical Society Museum at 113 E. 4th St.
10. **TR** on **MARKET ST.** 1 block to **3RD ST.**
11. **TL** on **3RD ST.** 1 block to **JEFFERSON ST.**, passing the former Spaunhorst General Store (NRHP) on the SE corner of 3rd and Jefferson.
12. **TL** on **JEFFERSON ST.** 1 block to **4TH ST.** When you reach 4th St. you can see Washington City Hall ahead on the right side of Jefferson at 405 Jefferson. [**3K**]
13. **TR** on **4TH ST.** for 1 block to **LAFAYETTE ST.**
14. **TR** on **LAFAYETTE ST.** for 1 block to **3RD ST.**
15. **TR** on **3RD ST.** for 1 block to **JEFFERSON ST.**
16. **TL** on **JEFFERSON ST.** for 1 block to **2ND ST.**

17. **TL** on **2ND ST.** for 2 blocks to **OAK ST.**, passing the Washington U.S. Post Office on the NW corner of 2nd and Lafayette.
18. **TL** on **OAK ST.** for 2 blocks to **4TH ST.**
19. **TR** on **4TH ST.** for 2 blocks to **CEDAR ST.** As you cross Elm St., look to your right for the Calvin Opera House ½ block north on Elm St.
20. **TR** on **CEDAR ST.** for 1 block to **3RD ST.** On the NW corner of 3rd and Cedar is the St. Francis Borgia Parrish Elementary School. **[4K]**
21. **TR** on **3RD ST.** for 1 block to **ELM ST.** As you turn east on 3rd St., look to your left, toward the river, and you can see the rear of St. Francis Borgia Catholic Church, which is located on Main St. between Elm and Cedar Streets.
22. **TL** on **ELM ST.** for 2 blocks to **MAIN ST.**, passing Cowan's Restaurant (Home of the Mile High Pies) at 114 Elm.
23. **TR** on **MAIN ST.** for 3 blocks to **JEFFERSON ST.**, passing the Main St. Creamery (Ice Cream!) at 110 W. Main St. **(SP)**
24. **TL** on **JEFFERSON ST.** for 1 block to **FRONT ST.**
25. **TL** on **FRONT ST.** for 1 block to **LAFAYETTE ST.**
26. **TR** on **LAFAYETTE ST.**, crossing the railroad tracks and walking toward the Missouri River.
27. As you approach the boat launch ramp, **TR** into the parking lot adjacent to the river. Walk through this parking lot, with river on your left, until you see the start of a bike path. **[NOTE: *If the river is high enough to cover this parking lot, just check out Riverfront Park (step 30), and go to step 31.*]**
28. **TR** onto the bike path for a short distance until you come to a fence just before the railroad tracks. At this point the bike path turns to the left, but you will
29. **TR** on the sidewalk, with the railroad tracks on your left. Straight ahead are **RESTROOMS.**
30. **CONTINUE** walking west, between the picnic pavilion on your right, and the Old Waterworks, now an antique store, on your left. Straight ahead is a large Analemmatic sundial. If the sun is shining, you can check the accuracy of your watch. Just north of the sundial, toward the river, is a large information sign with the

history of Washington, MO. Just west is another information sign which tells about the Lewis and Clark Expedition passing this site. You are almost finished, so if you wish to relax and enjoy the view of the Missouri River, there are benches to do so.

31. **RETURN** to **LAFAYETTE ST.**, re-cross the railroad tracks, and **TR** on **FRONT ST.**, back to the Start Point at the Amtrak Station / Visitor Center.

The St. Louis-Stuttgart Volksmarch Club hopes you enjoyed this walk through historic Washington, Missouri. You have walked past many of the historic points of interest in Washington. To see those you missed, pick up a Washington Historic Society Self-Guided Tour map in the Visitor Center.

Please refer any questions or comments on this walk to the walk POCs – DeAnne & Gordon Brown.

(D) deeebee333@gmail.com

(G) brownstl@swbell.net

Phone: 314-878-8647

Please visit our web-site

<https://www.saintlouiswalkers.com/> for

information on other walks in the St. Louis Metro area.



**AMERICA'S
WALKING CLUB**
— ESTABLISHED 1976 —

WASHINGTON, MO 5K WALK ROUTE

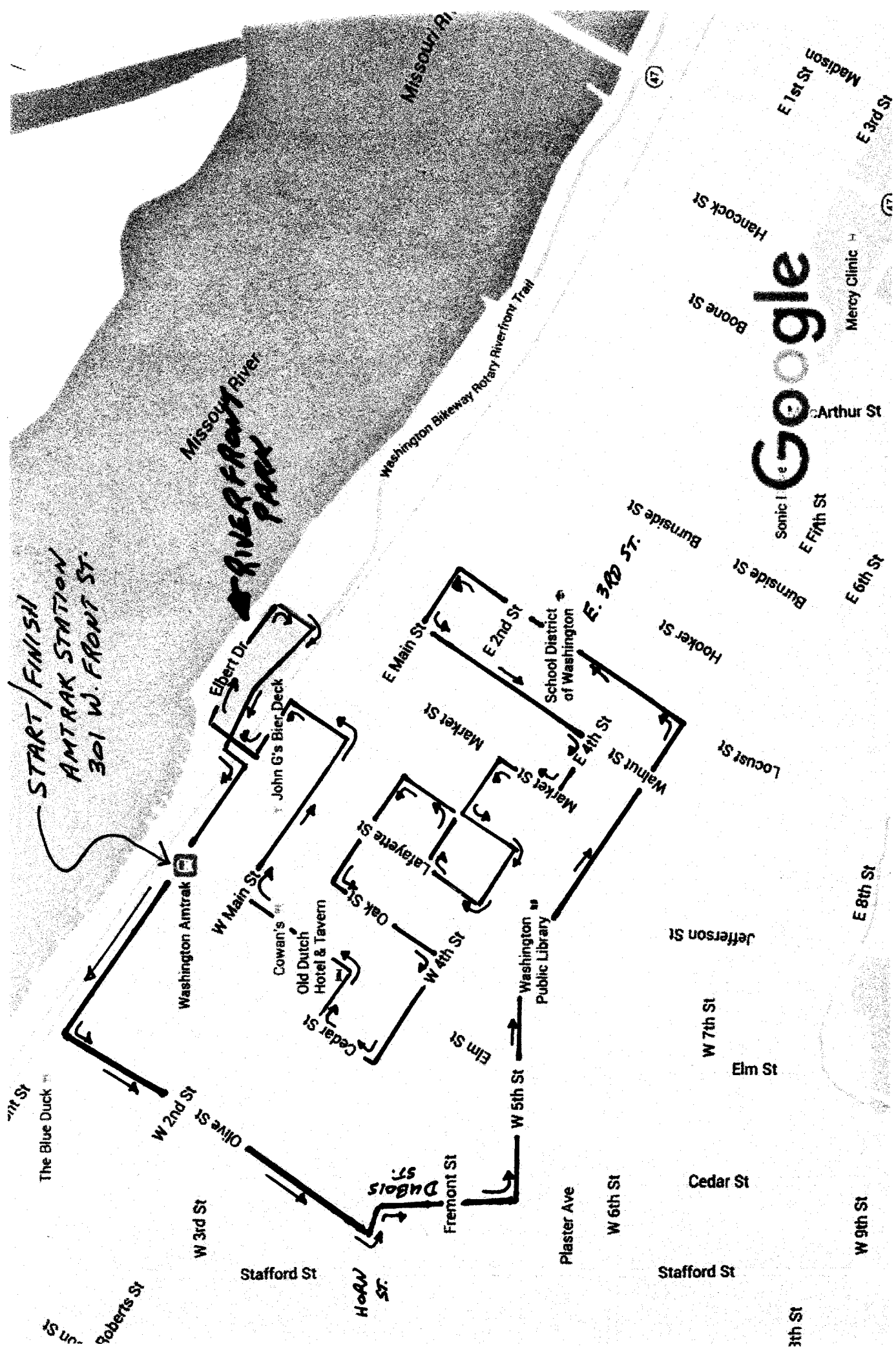

START/FINISH
AMTRAK STATION
301 W. FRONT ST.

MISSOURI RIVER
MISSOURI RIVER PARK

Google

Washington Amtrak
John G's Bier Deck
Old Dutch Hotel & Tavern
Washington Public Library
School District of Washington
Mercy Clinic
The Blue Duck
Cowan's
Cedar St
Elm St
Fremont St
Plaster Ave
Stafford St
W 3rd St
W 4th St
W 5th St
W 6th St
W 7th St
W 8th St
W 9th St
W 10th St
W 11th St
W 12th St
W 13th St
W 14th St
W 15th St
W 16th St
W 17th St
W 18th St
W 19th St
W 20th St
W 21st St
W 22nd St
W 23rd St
W 24th St
W 25th St
W 26th St
W 27th St
W 28th St
W 29th St
W 30th St
W 31st St
W 32nd St
W 33rd St
W 34th St
W 35th St
W 36th St
W 37th St
W 38th St
W 39th St
W 40th St
W 41st St
W 42nd St
W 43rd St
W 44th St
W 45th St
W 46th St
W 47th St
W 48th St
W 49th St
W 50th St
W 51st St
W 52nd St
W 53rd St
W 54th St
W 55th St
W 56th St
W 57th St
W 58th St
W 59th St
W 60th St
W 61st St
W 62nd St
W 63rd St
W 64th St
W 65th St
W 66th St
W 67th St
W 68th St
W 69th St
W 70th St
W 71st St
W 72nd St
W 73rd St
W 74th St
W 75th St
W 76th St
W 77th St
W 78th St
W 79th St
W 80th St
W 81st St
W 82nd St
W 83rd St
W 84th St
W 85th St
W 86th St
W 87th St
W 88th St
W 89th St
W 90th St
W 91st St
W 92nd St
W 93rd St
W 94th St
W 95th St
W 96th St
W 97th St
W 98th St
W 99th St
W 100th St
E Main St
E 2nd St
E 3rd St
E 4th St
E 5th St
E 6th St
E 7th St
E 8th St
E 9th St
E 10th St
E 11th St
E 12th St
E 13th St
E 14th St
E 15th St
E 16th St
E 17th St
E 18th St
E 19th St
E 20th St
E 21st St
E 22nd St
E 23rd St
E 24th St
E 25th St
E 26th St
E 27th St
E 28th St
E 29th St
E 30th St
E 31st St
E 32nd St
E 33rd St
E 34th St
E 35th St
E 36th St
E 37th St
E 38th St
E 39th St
E 40th St
E 41st St
E 42nd St
E 43rd St
E 44th St
E 45th St
E 46th St
E 47th St
E 48th St
E 49th St
E 50th St
E 51st St
E 52nd St
E 53rd St
E 54th St
E 55th St
E 56th St
E 57th St
E 58th St
E 59th St
E 60th St
E 61st St
E 62nd St
E 63rd St
E 64th St
E 65th St
E 66th St
E 67th St
E 68th St
E 69th St
E 70th St
E 71st St
E 72nd St
E 73rd St
E 74th St
E 75th St
E 76th St
E 77th St
E 78th St
E 79th St
E 80th St
E 81st St
E 82nd St
E 83rd St
E 84th St
E 85th St
E 86th St
E 87th St
E 88th St
E 89th St
E 90th St
E 91st St
E 92nd St
E 93rd St
E 94th St
E 95th St
E 96th St
E 97th St
E 98th St
E 99th St
E 100th St
Hancock St
Boone St
Burnside St
Hooker St
Locust St
Jefferson St
W 7th St
Elm St
Cedar St
Stafford St
Plaster Ave
W 6th St
W 9th St
3rd St
4th St
5th St
6th St
7th St
8th St
9th St
10th St
11th St
12th St
13th St
14th St
15th St
16th St
17th St
18th St
19th St
20th St
21st St
22nd St
23rd St
24th St
25th St
26th St
27th St
28th St
29th St
30th St
31st St
32nd St
33rd St
34th St
35th St
36th St
37th St
38th St
39th St
40th St
41st St
42nd St
43rd St
44th St
45th St
46th St
47th St
48th St
49th St
50th St
51st St
52nd St
53rd St
54th St
55th St
56th St
57th St
58th St
59th St
60th St
61st St
62nd St
63rd St
64th St
65th St
66th St
67th St
68th St
69th St
70th St
71st St
72nd St
73rd St
74th St
75th St
76th St
77th St
78th St
79th St
80th St
81st St
82nd St
83rd St
84th St
85th St
86th St
87th St
88th St
89th St
90th St
91st St
92nd St
93rd St
94th St
95th St
96th St
97th St
98th St
99th St
100th St

WASHINGTON, MO **10K** YRE 1408 WALK DIRECTIONS (OSB) (RATING 2A)

COPYRIGHT © 2020 – South Central Region, AVA: America's Walking Club

This map and directions may only be used in conjunction with a signed American Volkssport Association (AVA) athletic waiver. All other uses are prohibited. In case of emergency: Dial 911

Driving directions to start point at Amtrak Train Station, 301 W. Front St., Washington, Missouri, 63090. (GPS: 38.561600,-91.012500) **From I-44 Exit #251**, go west on Hwy. 100 for 10 miles to Washington. Turn right on Hwy. 47, left on 5th St., right on Jefferson St., left on W. Front St. to # 301. **From I-70 Exit #193**, go south on Hwy. 47 for 25 miles to Washington. Turn right on 5th St., right on Jefferson St., left on W. Front St. to # 301. **From I-64/Hwy 40 Exit #10**, go west on Hwy. 94, then left on Hwy. 47 to Washington. Turn right on 5th St., right on Jefferson St., left on W. Front St. to # 301. Free parking on Amtrak parking lot, Oak and Front Streets, across the street from train station. Rest rooms in train station and on the trail.

NOTE: Please use **EITHER** the Online Start Box (**OSB**) **OR** the Physical Start Box (**PSB**) to register and complete this event. Do NOT mix and match, for example, by registering using the OSB then completing your event using the PSB and/or signing the PSB log sheet. The sponsoring club only receives credit for an OSB participation when an OSB registration has been completed online by entering your participation date, distances, and any special programs using the OSB.

OSB COMPLETION AND CREDIT: Be sure to log back into the OSB system to "finish/complete" your online registration after doing the event. The OSB system does not deduct any event fee from a participant's Event Bank until they have submitted event completion info including the date of the event, the distance, and the selection of applicable special programs that person is participating in. (Nevertheless, a fee of \$2 for a downloaded PDF is deducted from the user's Event Bank when the PDF is downloaded. Later, any PDF fees are credited back to a user's Event Bank when he/she submits the event completion info as a paying for credit participant. Note, however, the \$2 coupon for the downloaded PDF will expire in 60 days.)

Special Programs: Ice Cream Parlors; Little Free Libraries (in Amtrak Station); Rockin' Around the Clock; Walking Missouri Counties (Franklin County)

Legend: TR = Turn Right, TL = Turn Left, SA = Straight Ahead, CR = Cross, SP = Special Program Qualifier

-
- EXIT** the Amtrak Depot, **TR** on **FRONT ST.** to **HIGH ST.** passing the Missouri Meerscham Co. at 400 Front St. (where corncob pipes are made).
 - TL** on **HIGH ST.** to **CIRCLE DRIVE**, passing Main Park on your right (**RESTROOMS** available in the brick building between the ball diamond and the park pavilion). [**1.2K**]
 - TR** on **CIRCLE DRIVE** (no sidewalk), passing the swimming pool on your right, to the next street on your left after passing the pool.
 - TL** on **STATE ST.** (not marked – it is the first street you can turn left on after passing the pool), 1-1/2 short blocks to **VETERANS DR.**
 - TR** on **VETERANS DR.** to a "Y" at the bottom of a short hill.
 - VEER LEFT** at the "Y" to **LAKE SHORE DR.** Go up a short hill on **LAKE SHORE DR.**, passing a sign for Bernie Hillermann Park on your left. At the top of the hill, go through a small parking area on your right and you will see **LIONS LAKE**, with a walking path around the lake.
 - TR** on the walking path, walking counter-clockwise around approximately 2/3 of the lake, and you will come to a pedestrian bridge over a small portion of the lake.
 - After crossing the bridge, leave the walking path and walk straight ahead, through a small parking lot, to a short flight of steps up to **LAKE SHORE DR.** (**RESTROOMS** available to the left of the playground).
 - TR** on **LAKE SHORE DR.** a short distance to **GRAND AVE.** [**2.7K**], passing the Kohmueller Farmstead (NRHP) on the left.
 - TL** on **GRAND AVE.** passing the YMCA at 400 Grand Ave. (**RESTROOMS**), to **5th ST.**
 - TL** on **5th ST.** to **ELM ST.** There is a Phillips 66 Station on the NW corner of 5th & Elm. [**4.8K**]
 - CR** **ELM ST.**, then **TR** on **ELM ST.** to **8th St.**, passing Immanuel Lutheran Church on your left at the SE corner of 5th & Elm.

13. **TL** on **8TH ST.** a short distance, **TR** and **CR** a small pedestrian bridge over Busch Creek. Straight ahead of you is the former John B. Busch Brewery (NRHP) (now a banquet center). After crossing the bridge, **TL and CONTINUE EAST ON BUSCH AVE.** (Busch Creek will be on your left) to **JEFFERSON ST.** On your right, at 813 Jefferson St., is the John B Busch Mansion (NRHP).
14. **TL** on **JEFFERSON ST.** At the corner, **CR 8TH ST.,** then **TR & CR JEFFERSON ST.**
15. **TL** on **JEFFERSON ST.** for 3 blocks to **5TH ST.**
16. **CROSS 5TH ST.,** then **TR** on **5TH ST.** for 3 blocks to **LOCUST ST. [6.4K],** passing St. Peter's United Church of Christ on the SW corner of 5th & Market.
17. **TL** on **LOCUST ST.** 4 blocks to **MAIN ST.**
18. **TL** on **MAIN ST.** 1 block to **WALNUT ST.**
19. **TL** on **WALNUT ST.** 3 blocks to **4TH ST. [7.2K]**
20. **TR** on **4TH ST.** 1 block to **MARKET ST.,** passing a former Presbyterian Church, now the Washington Historical Society Museum at 113 E. 4th St.
21. **TR** on **MARKET ST.** 1 block to **3RD ST.**
22. **TL** on **3RD ST.** 1 block to **JEFFERSON ST.,** passing the former Spaunhorst General Store (NRHP) on the SE corner of 3rd and Jefferson.
23. **TL** on **JEFFERSON ST.** 2 blocks to **5TH ST.,** passing City Hall at 405 Jefferson.
24. **TR** on **5TH ST.** for 1 block, passing the Washington Public Library (**RESTROOMS**), to **LAFAYETTE ST.**
25. **TR** on **LAFAYETTE ST.** for 2 blocks to **3RD ST.**
26. **TR** on **3RD ST.** for 1 block to **JEFFERSON ST. [8K]**
27. **TL** on **JEFFERSON ST.** for 1 block to **2ND ST.**
28. **TL** on **2ND ST.** for 2 blocks to **OAK ST.,** passing the Washington Post Office on the NW corner of 2nd and Lafayette.
29. **TL** on **OAK ST.** for 1 block to **3RD ST.**
30. **TR** on **3RD ST.** for 1 block to **ELM ST.**
31. **TL** on **ELM ST.** for 1 block to **4TH ST.,** passing the Calvin Opera House on your right.
32. **TR** on **4TH ST.** for 1 block to **CEDAR ST.**
33. **TR** on **CEDAR ST.** for 1 block to **3RD ST.** On the NW corner of 3rd and Cedar is the St. Francis Borgia Parrish Elementary School.
34. **TR** on **3RD ST.** for 1 block to **ELM ST.** As you turn east on 3rd St., look to your left, toward the river, and you can see the rear of St. Francis Borgia Catholic Church, which is located on Main St. between Elm and Cedar Streets.
35. **TL** on **ELM ST.** for 2 blocks to **MAIN ST. [9K],** passing Cowan's Restaurant (Home of the Mile High Pies) at 114 Elm.
36. **TR** on **MAIN ST.** for 3 blocks to **JEFFERSON ST.,** passing the Main St. Creamery (Ice Cream!) at 110 W. Main St. (**SP**)
37. **TL** on **JEFFERSON ST.** for 1 block to **FRONT ST.**
38. **TL** on **FRONT ST.** for 1 block to **LAFAYETTE ST.**
39. **TR** on **LAFAYETTE ST.,** crossing the railroad tracks and walking toward the Missouri River.
40. As you approach the boat launch ramp, **TR** into the parking lot adjacent to the river. Walk through this parking lot, with river on your left, until you see the start of a bike path. [**NOTE: If the river is high enough to cover this parking lot, just check out Riverfront Park (step 43), and go to step 44.**]
41. **TR** onto the bike path for a short distance until you come to a fence just before the railroad tracks. At this point the bike path turns to the left, but you will
42. **TR** on the sidewalk, with the railroad tracks on your left. Straight ahead are **RESTROOMS.**
43. **CONTINUE** walking west, between the picnic pavilion on your right, and the Old Waterworks, now an antique store, on your left. Straight ahead is a large Analemmatic sundial. If the sun is shining, you can check the accuracy of your watch. Just north of the sundial, toward the river, is a large information sign with the history of Washington, MO. Just west is another information sign which tells about the Lewis and Clark Expedition passing this site. You are almost finished, so if you wish to relax and enjoy the view of the Missouri River, there are benches to do so.
44. **RETURN** to **LAFAYETTE ST.,** re-cross the railroad tracks, and **TR** on **FRONT ST.,** back to the Start Point at the Amtrak Station / Visitor Center.

The St. Louis-Stuttgart Volksmarch Club hopes you enjoyed this walk through historic Washington, Missouri. You have walked past many of the historic points of interest in Washington. To see those you missed, pick up a Washington Historic Society Self-Guided Tour map in the Visitor Center.

Please refer any questions or comments on this walk to the walk POCs – DeAnne & Gordon Brown.

(D) deeebee333@gmail.com

(G) brownstl@swbell.net

Phone: 314-878-8647

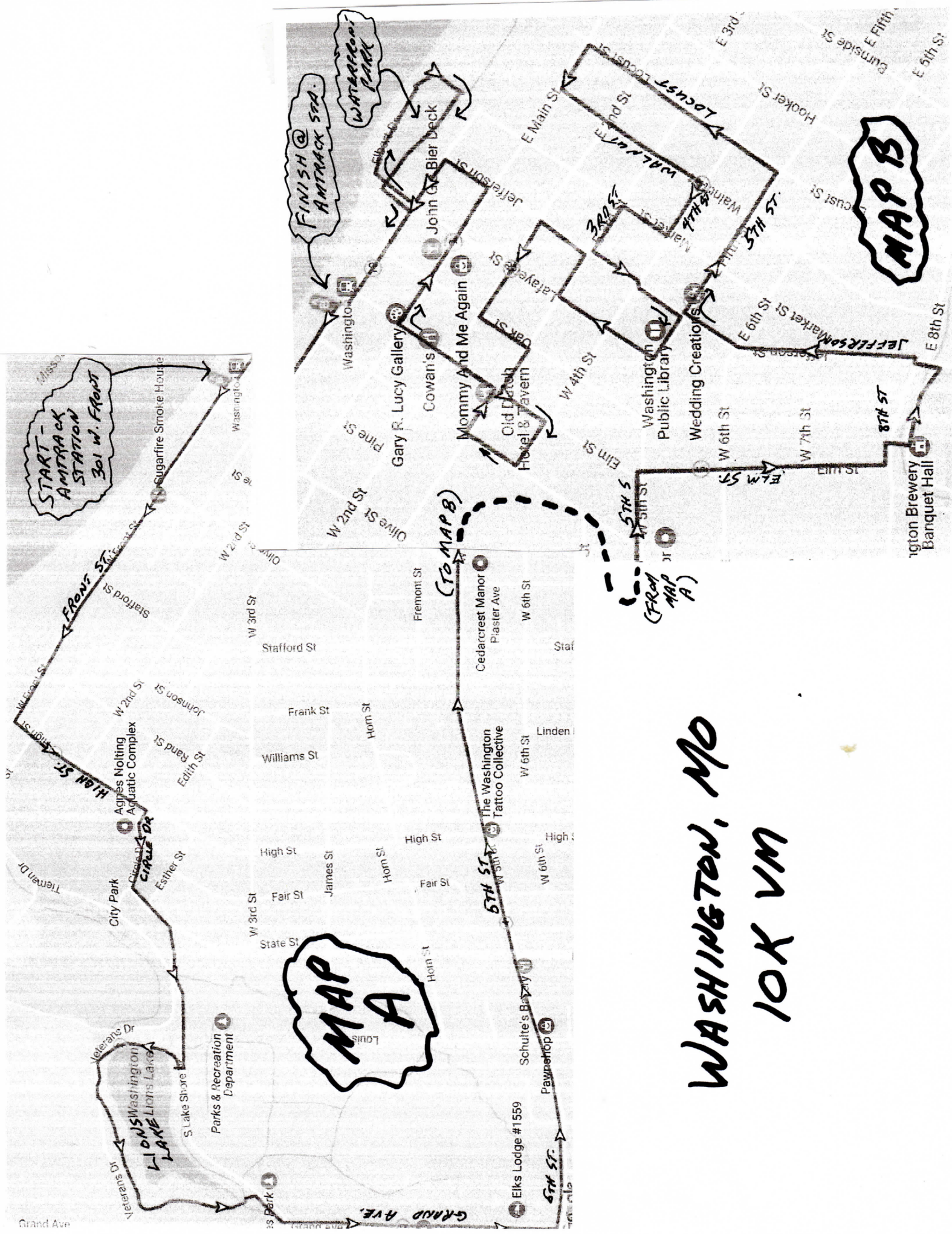

WASHINGTON, MO
10K VM