

INSTRUCTIONS Klamath Falls, Oregon 5/10 km walks

Klamath County

5 KM and 10 KM Rated 1A – Stamp # Y1834

Walk Start Location: Veterans Memorial Park at the Restrooms, 31 George Nurse Way, Klamath Falls, OR

GPS Coords: 42.2 – 121.8

Restrooms available at Start

DRIVING DIRECTIONS: DRIVING DIRECTIONS: Southbound US 97 to Klamath Falls. Take Business North US 97 to West Main St Exit. RIGHT on W Main St to an immediate RIGHT down to Veterans Memorial Park, No Street Sign. Northbound US 97 the Dalles-California Hwy. Take the Klamath Falls City Center exit to US 97. Stay Right to W Main. Immediate right on the first street you come to. No street sign to Veterans Memorial Park restrooms.

PARK: Park in Arthur Park parking lot

Walk completion and Credit: Be sure to log back into the OSB to finish/complete your online registration after doing the event. The OSB system does not deduct any event fee from a participant's Event Bank until they have submitted event completion info including the event was walked, the distance walked, and the selection of applicable special programs that person is participating in. (Nevertheless, a fee of \$2 for a download PDF is deducted from the user's Event Bank when the PDF is downloaded. Later, any PDF fees are credited back to a user's Event Bank when he/she submits the event completion info as a paying for credit participant. Note, however, the \$2 coupon for the downloaded PDF will expire in 60 days).

KLAMATH FALLS, OREGON

5 Km, Rated 1A

These walking instructions and maps may only be used in conjunction with a signed American Volkssport Association athletic waiver. All other uses are prohibited. For emergencies: contact 911. Walk owner is Martha Korff and she can be reached at 503-369-9906.

<ol style="list-style-type: none"> 1. From parking lot as you face Veterans Park Restrooms with Lake Ewauna at your back, you are on George Nurse Way 2. Turn RIGHT to the end of the parking lot and keep the Southern Pacific Steam Engine on your left, walk on the right sidewalk. 3. Street name will change to Klamath Ave (1 km at 8th St) 4. LEFT on S Broad St to Main St 5. RIGHT on Main St just after walking under the RR tracks the street curves to the right. You're still on Main St to Oak. (museum is Klamath Falls Armory Auditorium at 1451 Main St on Nat'l Registry 6. RIGHT on Oak Ave to SE 7th St (2 km) 7. RIGHT on SE 7th St to Walnut Ave Option: For Eagle Ridge High School, go Left on 7th St to Willow Ave to right on 6th St to right on Plum Ave to LEFT on 7th Ave. 	<ol style="list-style-type: none"> 8. RIGHT on Walnut Ave to S 11th St 9. LEFT on S 11th S Main St (3 km) 10. LEFT on S Main St to 2d St 11. LEFT on S 2d St to Klamath Ave (4 km) 12. CROSS then RIGHT on Klamath Ave to pass the Southern Pacific steam engine on your right to paved path 13. LEFT on first paved path to Lake Ewauna (watch for pelicans and other water fowl) 14. LEFT at the Lake to the Wooden Bridge and then return to Veterans Memorial parking lot. 15. LEFT in the Veterans Memorial Parking lot to restrooms and finish

Klamath Falls, Oregon _ 5K

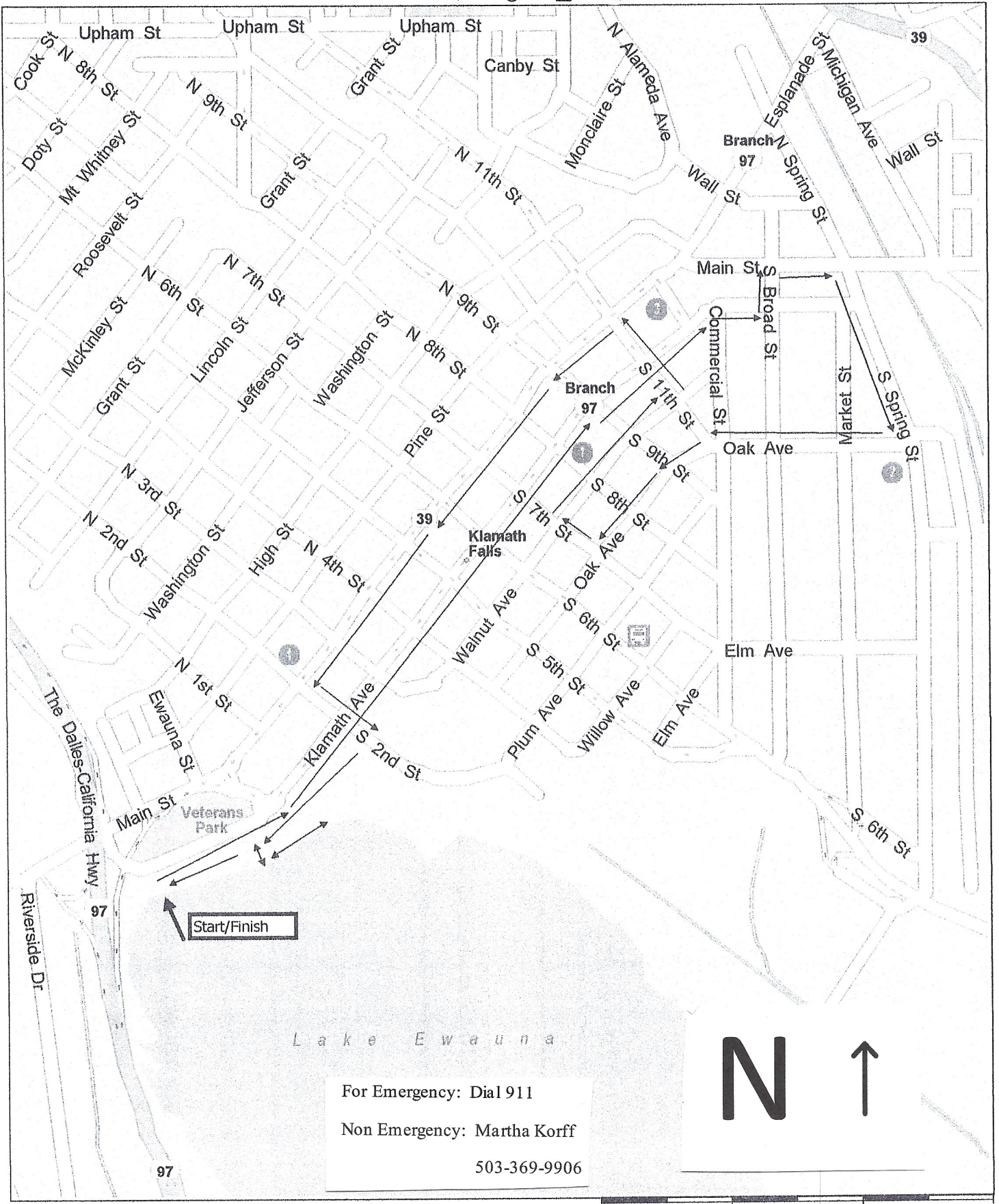

For Emergency: Dial 911
 Non Emergency: Martha Korff
 503-369-9906



Copyright © and (P) 1988–2012 Microsoft Corporation and/or its suppliers. All rights reserved. <http://www.microsoft.com/streets/>
 Certain mapping and direction data © 2012 NAVTEQ. All rights reserved. The Data for areas of Canada includes information taken with permission from Canadian authorities, including: © Her Majesty the Queen in Right of Canada, © Queen's Printer for Ontario. NAVTEQ and NAVTEQ ON BOARD are trademarks of NAVTEQ. © 2012 Tele Atlas North America, Inc. All rights reserved. Tele Atlas and Tele Atlas North America are trademarks of Tele Atlas, Inc. © 2012 by Applied Geographic Solutions. All rights reserved. Portions © Copyright 2012 by Woodall Publications Corp. All rights reserved.

KLAMATH FALLS, OREGON

Klamath County

10Km, Rated 1A

These walking instructions and maps may only be used in conjunction with a signed American Volkssport Association athletic waiver. All other uses are prohibited. For emergencies: contact 911. Walk owner is Martha Korff and she can be reached at 503-369-9906.

<ol style="list-style-type: none">1. From parking lot as you face Veterans Park Restrooms with Lake Ewauna at your back, you are on George Nurse Way2. Turn RIGHT to the end of the parking lot and keep the Southern Pacific Steam Engine on your left, walk on the right side walk. Street name will change to Klamath Ave (1 km at 8th St)3. LEFT on S Broad St to Main St4. RIGHT on Main St just after walking under the RR tracks the street curves to the right. You're still on Main St to Oak. (museum is Klamath Falls Armory Auditorium at 1451 Main St on Nat'l Registry5. LEFT on Oak Ave to Martin St (2 km)6. LEFT on Martin to Main St7. RIGHT on Main St to paved path8. RIGHT on paved path just before the water canal #2 to Washburn9. RIGHT at the stop sign on Washburn Way to Orchard Ave	<ol style="list-style-type: none">10. RIGHT at the stop sign on Washburn Way to Orchard Ave11. LEFT on Orchard Ave to Cross Washburn Way then RIGHT so you're walking on the left side of Washburn Way to Shasta Way (4 km)12. RIGHT on Shasta Way to S 6th St13. RIGHT on S 6th (no sign at the T) to Walnut Ave (up and over tracks) (6 km)14. RIGHT on Walnut Ave to S 11th St15. LEFT on S 11th St to Main St16. LEFT on Main St to S 2d St (8 km)17. LEFT on S 2d to Klamath Ave18. Cross then RIGHT on Klamath Ave to pass the Southern Pacific Steam engine on your right to paved path (9 km)19. LEFT on first paved path to Lake Ewauna20. LEFT at the lake to the Wooden Bridge and then return to Veterans Memorial parking lot.21. LEFT in the Veterans Memorial Parking lot to the restrooms and finish
---	---

Klamath Falls, Oregon 10K 2012

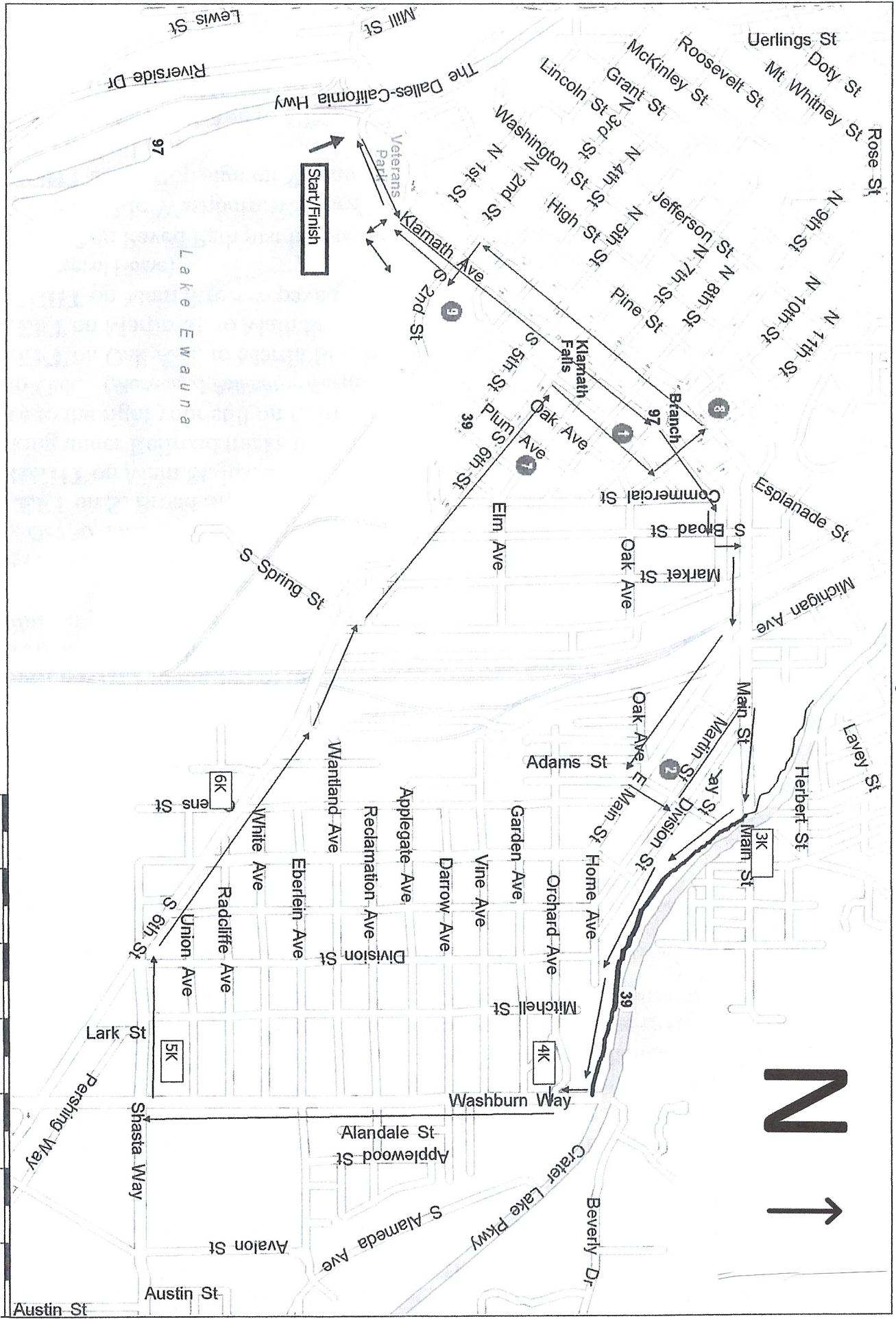

Copyright © and (P) 1988-2012 Microsoft Corporation and/or its suppliers. All rights reserved. <http://www.microsoft.com/streets/>
 Certain mapping and direction data © 2012 NAVTEQ. All rights reserved. The Data for areas of Canada includes information taken with permission from Canadian authorities, including © Her Majesty the Queen in Right of Canada © Queen's Printer for Ontario. NAVTEQ and NAVTEQ ON BOARD are trademarks of NAVTEQ. © 2012 Tele Atlas North America, Inc. All rights reserved. Tele Atlas and Tele Atlas North America are trademarks of Tele Atlas, Inc. © 2012 by Applied Geographic Solutions. All rights reserved. Portions © Copyright 2012 by Woodall Publications Corp. All rights reserved.